

# POTOMAC YARD METRORAIL STATION PROJECT

City Council Update  
October 6, 2020

# Agenda

- Project Update:
  - Southwest Access
  - Construction
  - Project Progress

# Southwest Access Update

## **Southwest Access (DSUP Amendment)**

- Final Site Plan
  - Planning Commission: November 5
  - City Council: November 14
- Subdivision plat
  - Planning Commission: November 5
- Final Site Plan and Building permit being reviewed concurrently

# Southwest Access: Pavilion



RENDERING – CORNER OF EAST GLEBE ROAD LOOKING EAST



# Southwest Access: Pavilion



RENDERING – FROM THE POTOMAC AVE LOOKING NORTH NTS

# Southwest Access: Pavilion



RENDERING .75- FROM POTOMAC AVENUE LOOKING NE NTS



# Southwest Access: Pedestrian Bridge & Emergency Egress Stairs

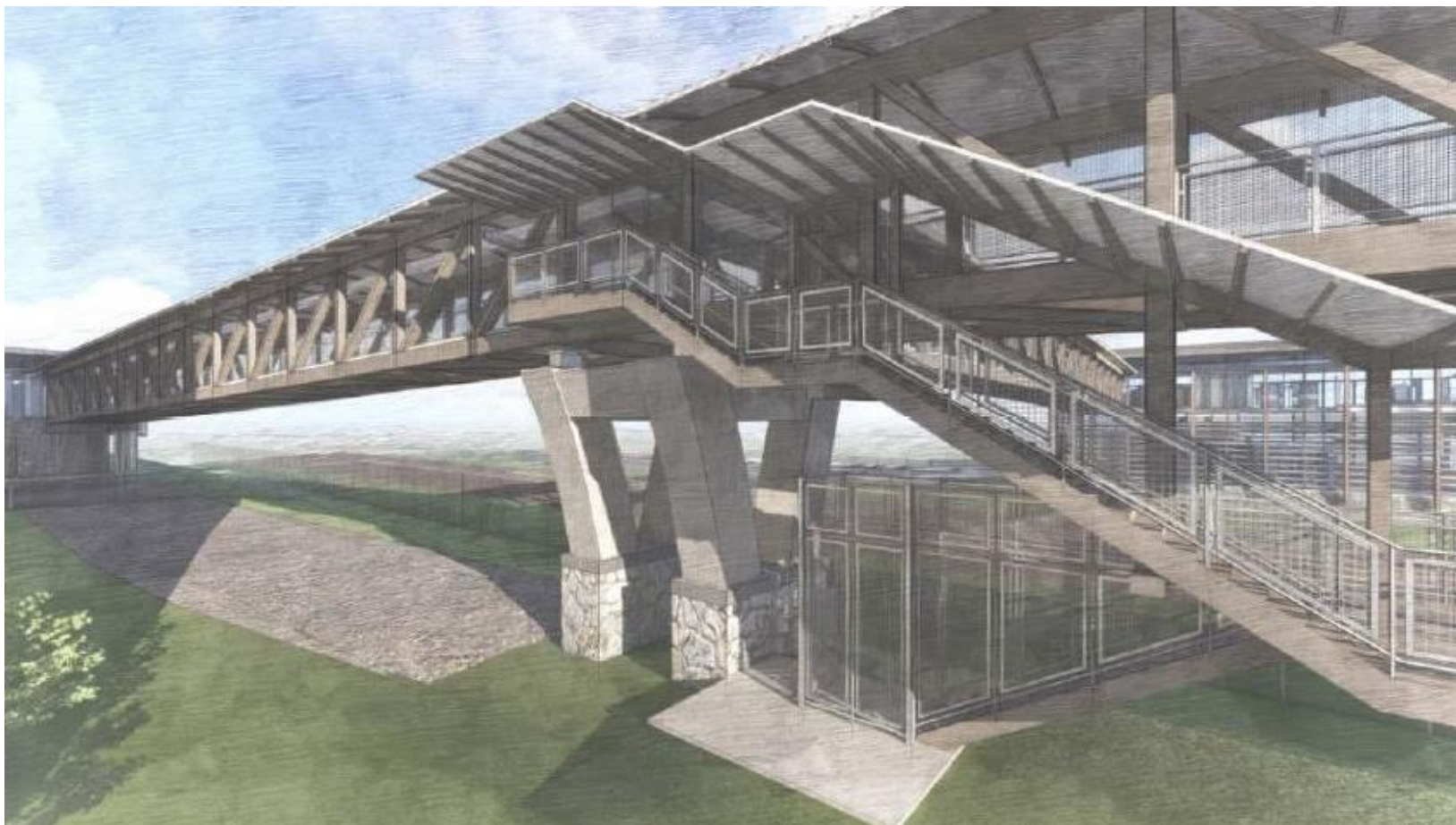

RENDERING – EMERGENCY EGRESS AT BRIDGE KNUCKLE

# Southwest Access

August 31 Southwest Access was presented to PYMIG via posted presentation

September 2<sup>nd</sup> - BAR approved the concept design of the Southwest Pavilion and Egress stairs

BAR ask the designers to review the following areas:

- Minimize the pavilion canopy
- Minimize the pavilion roof

September 21- PYMIG was provided the opportunity to comment on the design during a Zoom meeting

October 21 - Present to the BAR for approval of mass, scale, and general architectural character - Certificate of Appropriateness





# Construction Update



# Construction Activities - Platform



# Construction Activities-East Headhouse





# Construction Activities-East Headhouse





# Construction Activities -Knuckle Pier



# Construction Activities - North Pavilion





# Construction Activities - North Pavilion



# Construction Activities- Project Schedule

ACTIVITY	2020			
	SEP	OCT	NOV	DEC
CONSTRUCTION OF AC SWITCHGEAR BUILDING				
PLACE FILL FOR STATION				
STATION FOUNDATIONS				
STATION PLATFORMS & MEZZANINE				
CONCRETE FOUNDATION/SLABS/WALLS AT NORTH PAVILION				
STEEL ERECTION AT NORTH PAVILION				
PIER - PLACE PILE CAP/BASE/COLUMN				
DESIGN & PERMITS - SW ENTRANCE				



# Project Progress Update

## Grant Funding

- Total Grant Funding Amount: \$70,500,000
- Reimbursement Received to Date: \$64,560,596 (94%)

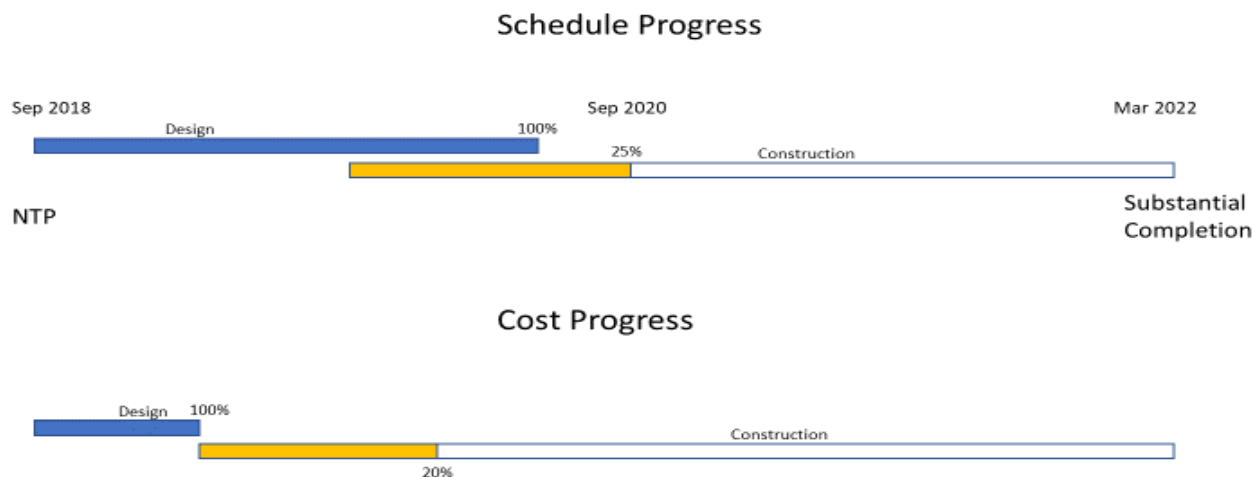

The Southwest Access is not included in these completion figures; but is planned for completion in parallel to the station construction.



# Discussion