

ORDINANCE NO. 5264

An Ordinance to amend and reordain subsection (l) (Agudas Achim Congregation Election District) of Section 2-2-10 (Establishment of Election Districts and Voting Places), and to amend and reordain "The Official Map of the City of Alexandria, Virginia, Designating Election Districts and Voting Places," adopted by Section 2-2-13 (Map of Election Districts and Polling Places), all of Chapter 2 (Elections), Title 2 (General Government) of The Code of the City of Alexandria, Virginia, 1981, as amended to rename the Agudas Achim Congregation Election District the Charles Barrett Center Election District and establish the Charles Barrett Center (in lieu of Agudas Achim Synagogue) as the polling place for this precinct for elections in 2020 and thereafter.

THE CITY COUNCIL OF ALEXANDRIA HEREBY ORDAINS:

Section 1. That Subsection (d) of Section 2-2-10 of The Code of the City of Alexandria, Virginia, 1981, as amended, be, and the same hereby is, amended and reordained to delete the text shown in strikethrough and add the text shown in underline as follows:

(l) The Agudas Achim Congregation Charles Barrett Center Election District shall be bounded and described by the census blocks shown on the map adopted by section 2-2-13 of this code as comprising the said district. The voting place within the Agudas Achim Congregation Charles Barrett Center Election District shall be at the Agudas Achim Congregation, located at 2908 Valley Drive Charles Barrett Center located at 1115 Martha Custis Drive.

Section 2. That "The Official Map of the City of Alexandria, Virginia, Designating Election Districts and Voting Places," adopted by Section 2-2-13 of the Code of the City of Alexandria, Virginia, 1981, as amended, be, and the same hereby is, amended and reordained as shown on Exhibit 1, attached hereto and incorporated fully by reference, to reflect the designation and description of: the Charles Barrett Center Election District, in replacement of the of the Agudas Achim Congregation Election District.

Section 3. That the general registrar of voters be, and she hereby is, directed to record the foregoing amendments on the said map.

Section 4. That this ordinance shall become effective upon the date and at the time of its final passage and the adjustments contained herein will be utilized for the elections in 2020 and thereafter until or unless further modified and amended.



JUSTIN M. WILSON
Mayor

ATTEST:



Gloria A. Sitton, CMC City Clerk

Ordinance Attachments

Exhibit 1: Alexandria Voting Districts, map produced December 31, 2019

Final Passage: January 25, 2020

Alexandria Voting Districts

Map Produced: 12/31/2019

Legend

★ Polling Place

□ Precincts

Virginia Senate Boundary

Virginia House Boundary

ABC School Board Districts

School District A			
ID	Polling Place	Address	House Senate
101	City Hall	301 King Street	45 35
102	City Hall	301 King Street	45 35
103	City Hall	301 King Street	45 35
104	City Hall	301 King Street	45 35
105	City Hall	301 King Street	45 35
106	City Hall	301 King Street	45 35
107	City Hall	301 King Street	45 35
108	City Hall	301 King Street	45 35
109	City Hall	301 King Street	45 35
110	City Hall	301 King Street	45 35
111	City Hall	301 King Street	45 35
112	City Hall	301 King Street	45 35
School District B			
ID	Polling Place	Address	House Senate
201	George Mason School	201 George Mason Road	45 35
202	George Mason School	201 George Mason Road	45 35
203	George Mason School	201 George Mason Road	45 35
204	George Mason School	201 George Mason Road	45 35
205	George Mason School	201 George Mason Road	45 35
206	George Mason School	201 George Mason Road	45 35
207	George Mason School	201 George Mason Road	45 35
208	George Mason School	201 George Mason Road	45 35
209	George Mason School	201 George Mason Road	45 35
210	George Mason School	201 George Mason Road	45 35
School District C			
ID	Polling Place	Address	House Senate
301	Patrick Henry Center	4603 Terry Avenue	45 35
302	Patrick Henry Center	4603 Terry Avenue	45 35
303	Patrick Henry Center	4603 Terry Avenue	45 35
304	Patrick Henry Center	4603 Terry Avenue	45 35
305	Patrick Henry Center	4603 Terry Avenue	45 35
306	Patrick Henry Center	4603 Terry Avenue	45 35
307	Patrick Henry Center	4603 Terry Avenue	45 35
308	Patrick Henry Center	4603 Terry Avenue	45 35
309	Patrick Henry Center	4603 Terry Avenue	45 35
310	Patrick Henry Center	4603 Terry Avenue	45 35

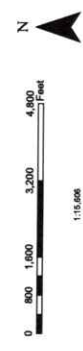

This map was produced by the GIS Division of the ITS Department, City of Alexandria, VA. Data Sources: Voting Precincts and Polling Places were provided by the Voter Registration Office, City of Alexandria, VA. Virginia State House and Senate Districts are based on HB5000 Ch. 1, Session 2011.

Map Scale: 1 inch = 1 mile
Map Units: Feet

This map is provided "as is" and the City expressly disclaims all liability for any errors or omissions. The City does not warrant the accuracy or completeness of the data or the map and its use for any purpose other than for informational purposes. The City is not responsible for any damages or losses resulting from the use of this map.

