



SUP#2018-0116

1400 Duke Street

City Council
March 16, 2019

Site Context

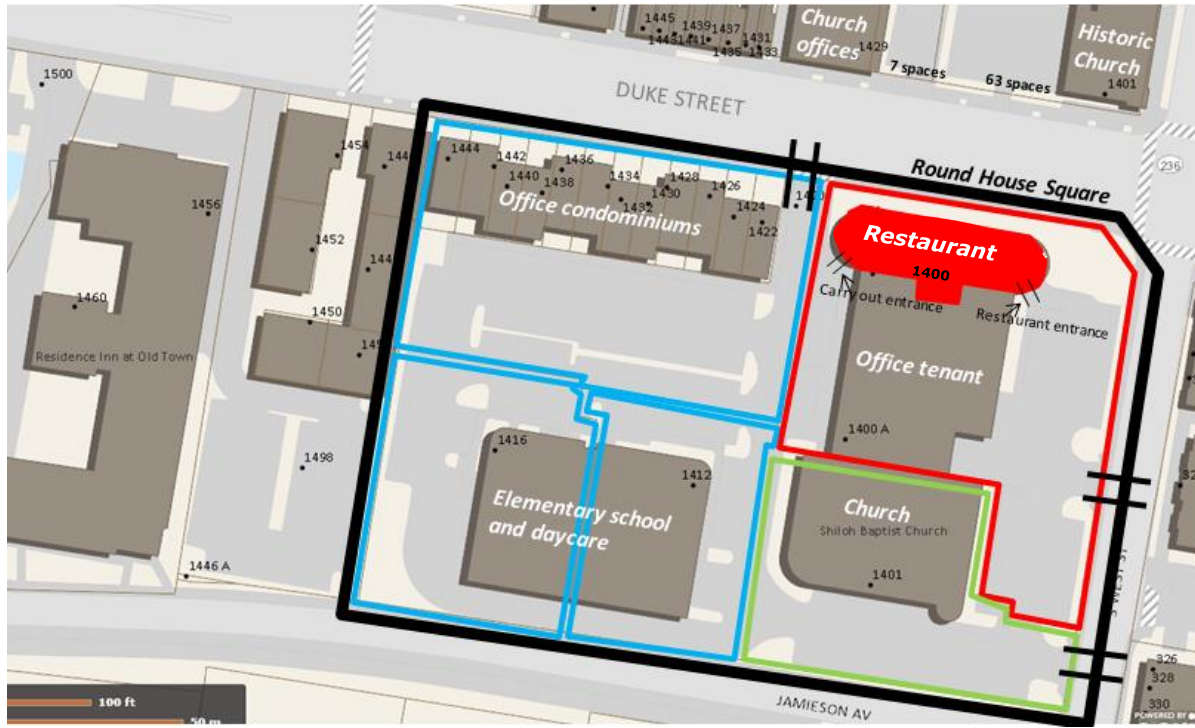

- Located on the corner of Duke and South West Streets
- Restaurant is sited in Round House Square development comprised of mixed uses
- Shared parking lot with 1400A Duke Street office tenant
- Zoned OCM (50)

SUP Request

Amend SUP 2016-0041 to:

- Add 27 indoor seats for a total of 141 seats
- Add eight outdoor seats on west patio
- Increase one-half hour of operation each morning. Hours of operation would be 5:30 a.m. – 12 midnight, daily



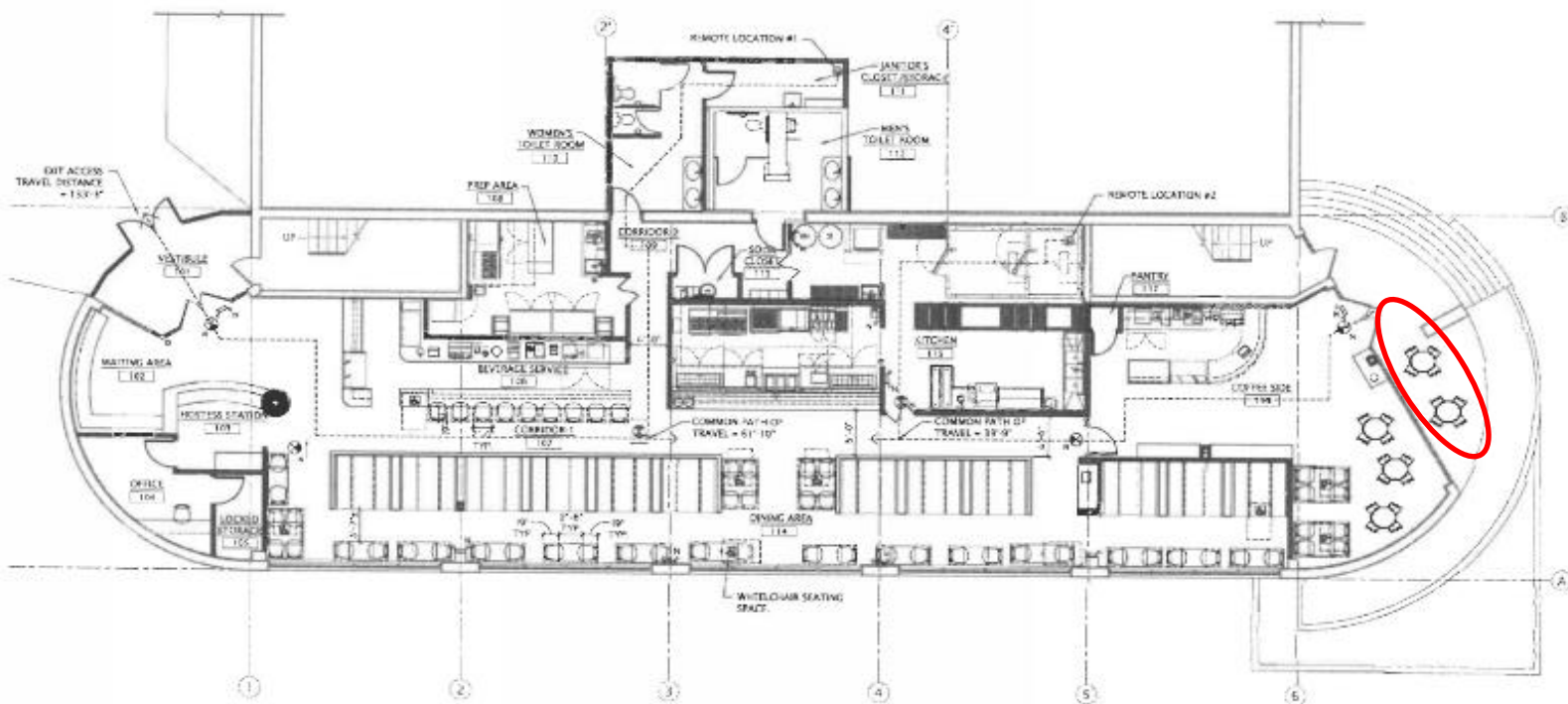

Planning Commission recommends **APPROVAL**

with an amendment to Condition 3 allowing
operating hours between 5 a.m. to 1 a.m., daily