

SMART SCALE Grant Applications FY 2028 to FY 2029

March 22, 2022





SMART SCALE – Scoring Criteria

Congestion
Mitigation
45%

Land Use 20%

Accessibility
15%

Environmental
Quality 10%

Safety 5%

Economic
Development
5%

Summary of *MAXIMUM* Funding Requests

City of Alexandria Projects	Maximum Funding Request
I-395 Ramp Improvements at Duke Street	Up to \$14 million
Duke Street and Van Dorn Street Intersection Improvements	Up to \$20 million
Metroway Extension	Up to \$10 million
DASH Facility Expansion – Phase II	Up to \$12 million



Prior Project Awards



Smart Scale Funding FY 2022 - FY 2026							
Project Name	PRIOR YEAR	FY22	FY23	FY24	FY25	FY26	PROJECT TOTAL
Safety and Capacity Enhancements (Duke St. and West Talor Run)	\$ 2,045,000			\$ 3,700,000			\$ 5,745,000
Broadband Link for Eisenhower Avenue	\$ 1,000,000						\$ 1,000,000
Traffic Adaptive Signal Comntrol	\$ 7,010,000	\$ 5,266,000	\$ 2,410,000				\$ 14,686,000
West End Transitway	\$ 2,934,000	\$ 4,505,000	\$ 4,029,000				\$ 11,468,000
DASH Bus Service and Facility Expansion	\$ 7,008,000	\$ 3,421,000	\$ 2,928,000	\$ 1,281,000			\$ 14,638,000
Access Impovements to the Landmark Transit Hub	\$ -			\$ 3,950,000	\$ 2,384,000		\$ 6,334,000
Citywide TSP on Major Corridors	\$ -			\$ 374,000	\$ 1,736,000		\$ 2,110,000
West End Transitway Corridor Investments	\$ -			\$ 23,610,000	\$ 33,590,000		\$ 57,200,000
DASH Zero Emission Fleet Expansion	\$ -			\$ 4,960,000	\$ 7,040,000		\$ 12,000,000
Route 1 and Glebe	\$ -					\$3,112,946	\$ 3,112,946
Route 1 South Median	\$ -					\$ 4,280,490	\$ 4,280,490
Landmark Mall Transit Center	\$ -					\$ 12,997,059	\$ 12,997,059
SMART Scale Total	\$ 19,997,000	\$ 13,192,000	\$ 9,367,000	\$ 37,875,000	\$ 44,750,000	\$ 20,390,495	\$ 145,571,495

Project 1: I-395 Ramp Improvements on Duke Street



Allows direct access from I-395 onto redeveloped Landmark site



Part of Landmark site development – City to install by 2027



Up to \$14 million

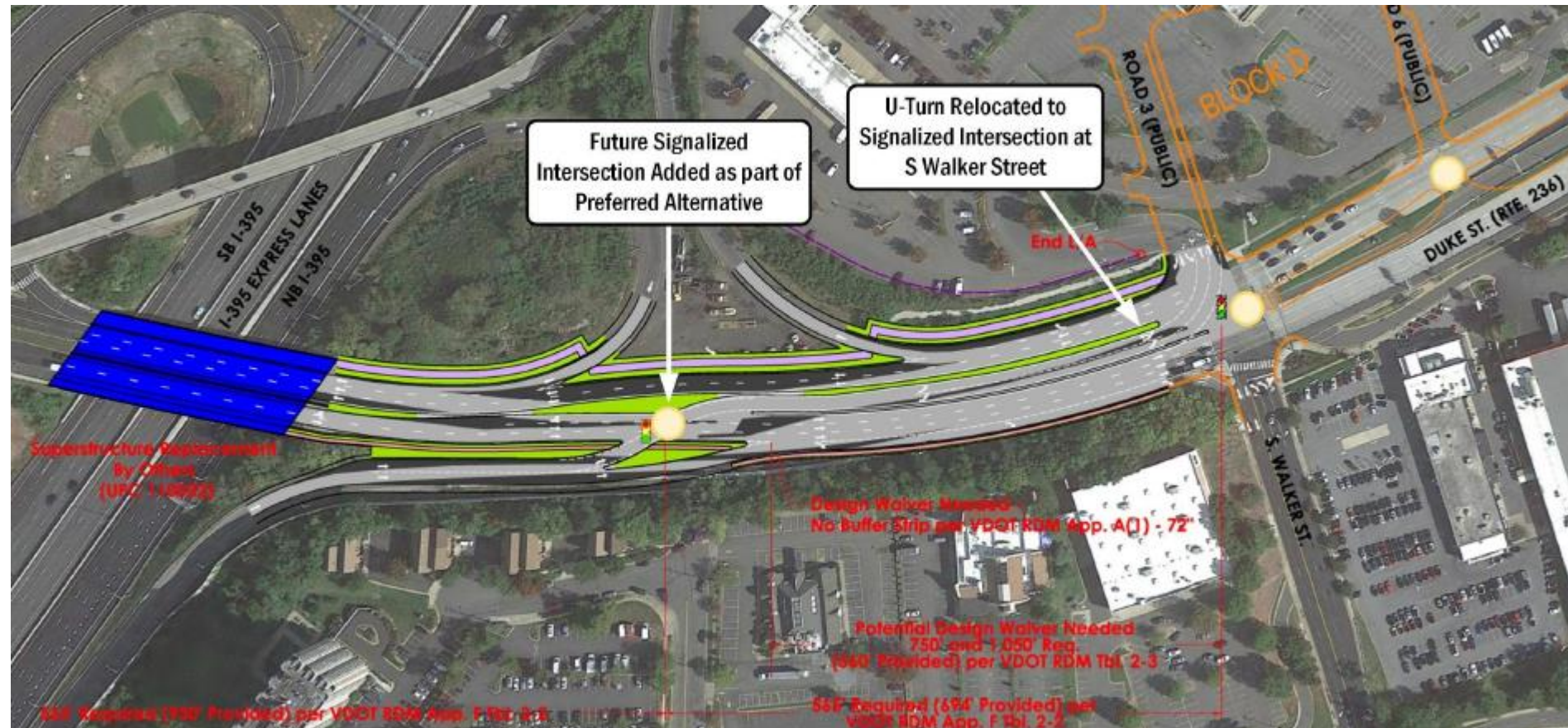

Project 2: Duke Street and Van Dorn St Intersection Improvements



Improves crosswalks on Duke St/Van Dorn south and east side, straightens access from NB Van Dorn onto EB Duke



Part of Landmark site development



Up to \$20 million

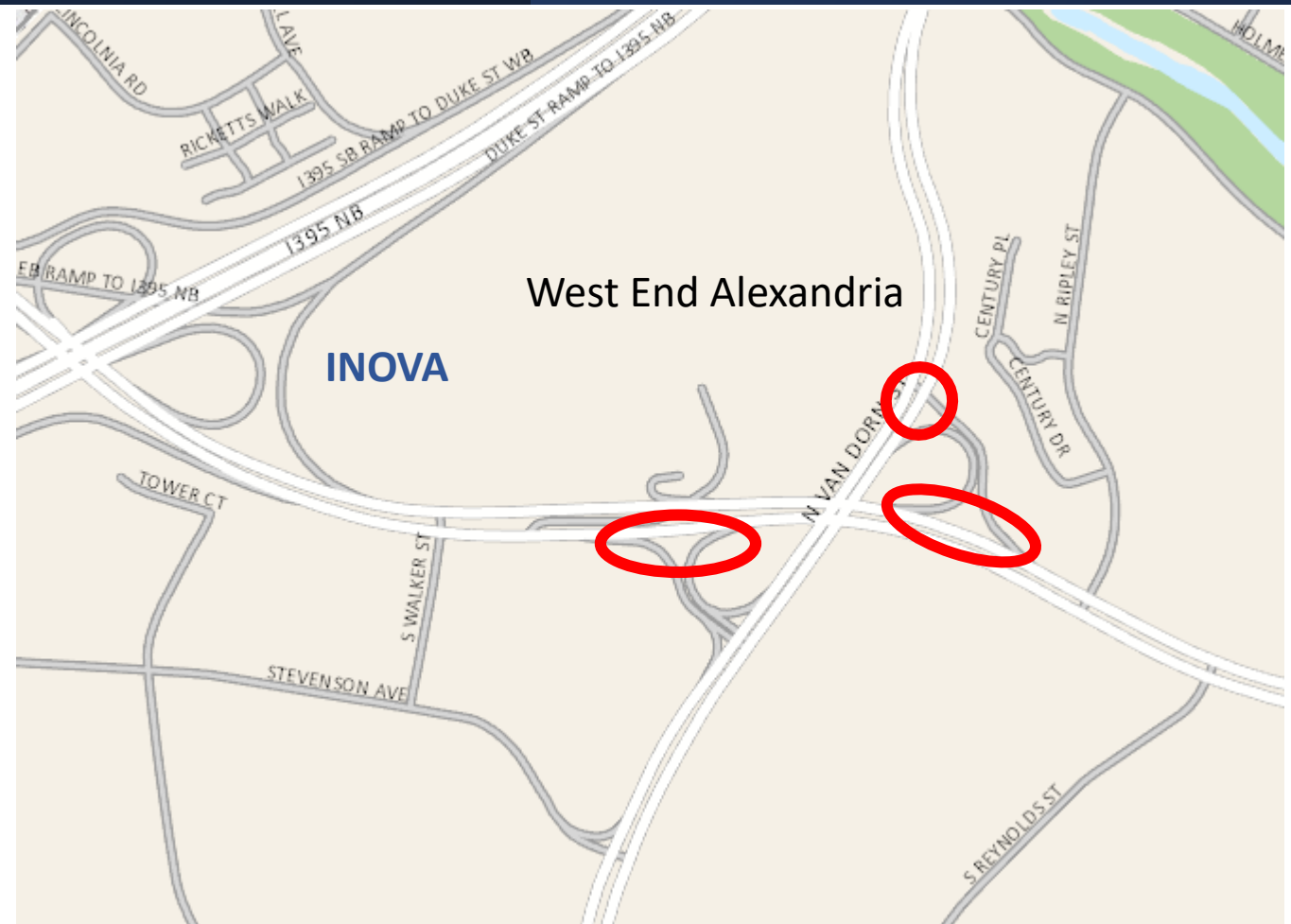

Project 3: Metroway Extension



Extension North
of Glebe Road to
Evans Lane



Sustainability for
EV and
stormwater



Up to \$10 million

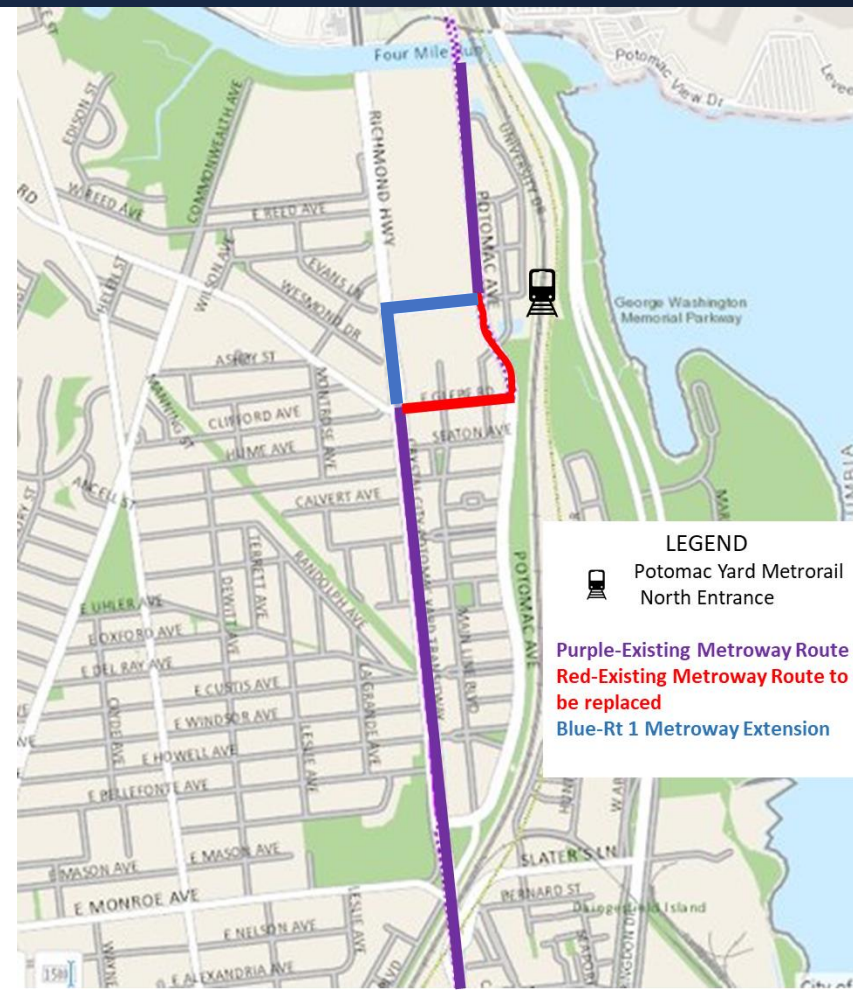

Project 4: DASH Facility Expansion Phase II



Transition to
100% Electric
Buses



20 additional
charging stations
in climate-
controlled facility.



Up to \$12 million

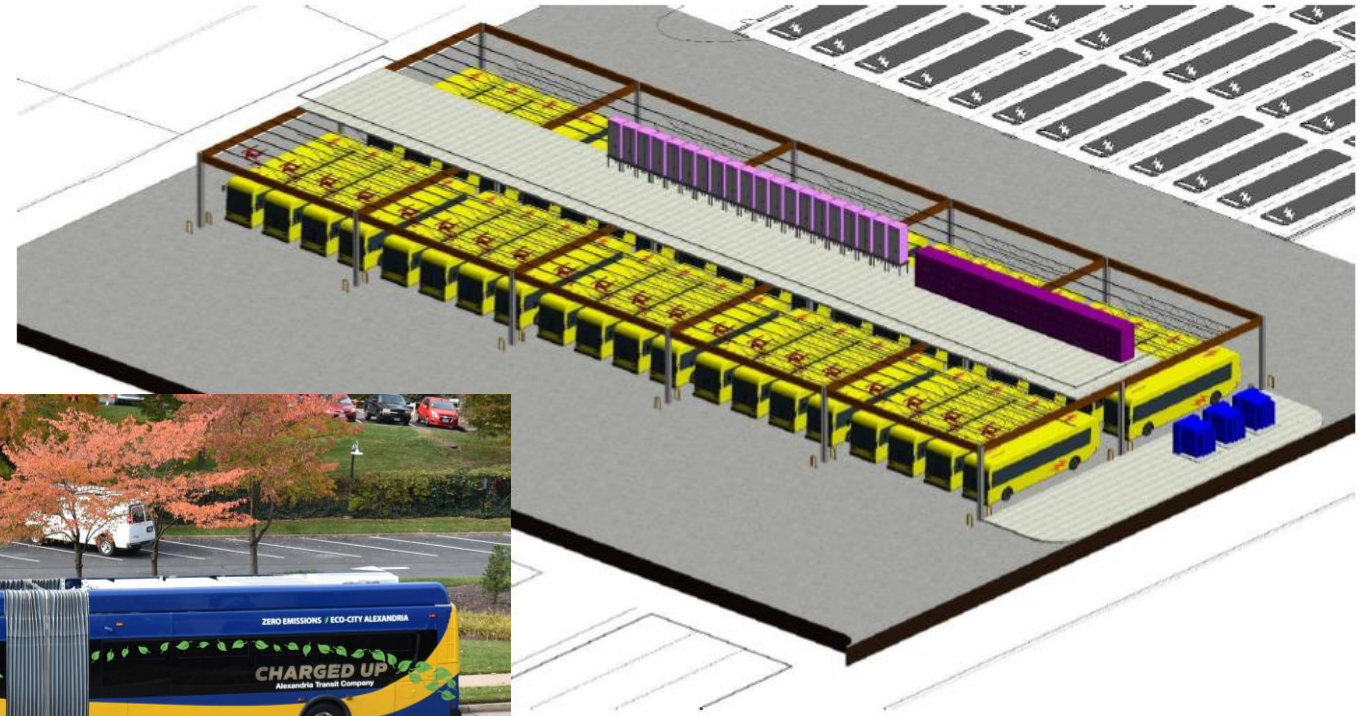



Next Steps

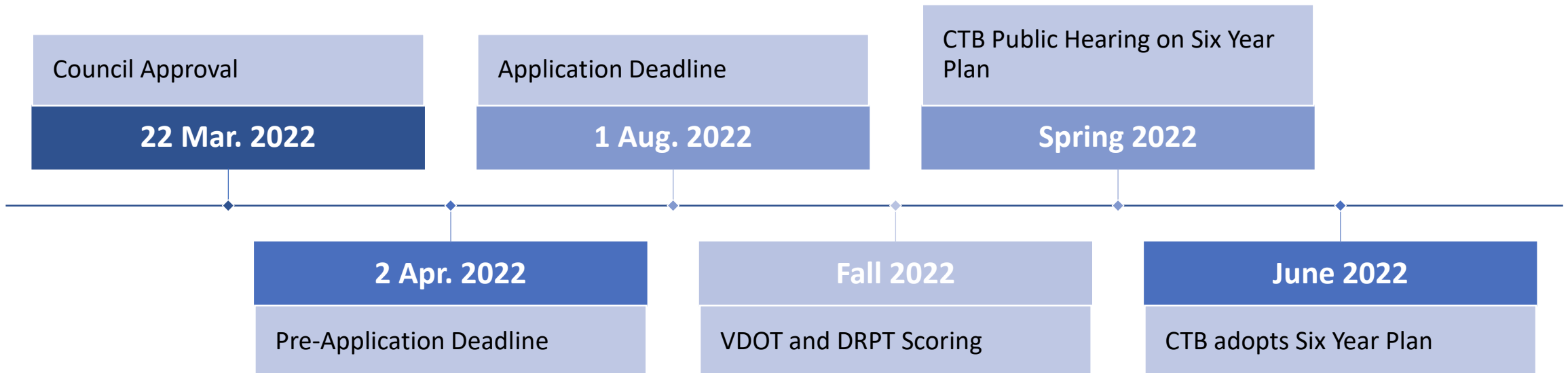

Recommendation

- That the City Council:
 - Authorize the submission of up to \$56 million in SMART SCALE applications.
 - Authorize the City Manager to execute all necessary documents that may be required.

