



*600 DULANY ST SOUTH LATERAL  
PROPOSED FIBER ROUTE  
CITY OF ALEXANDRIA, VA  
ZAYO JOB# ISO-0400904*

**CITY OF ALEXANDRIA PERMIT**

*OCTOBER 03, 2023*

**ISSUED FOR  
CONSTRUCTION**



10701 STONER DR  
FREDERICKSBURG, VA 22408  
540-710-5416  
WWW.KCI.COM

**SITE MAP**  
**CITY OF ALEXANDRIA, VA**

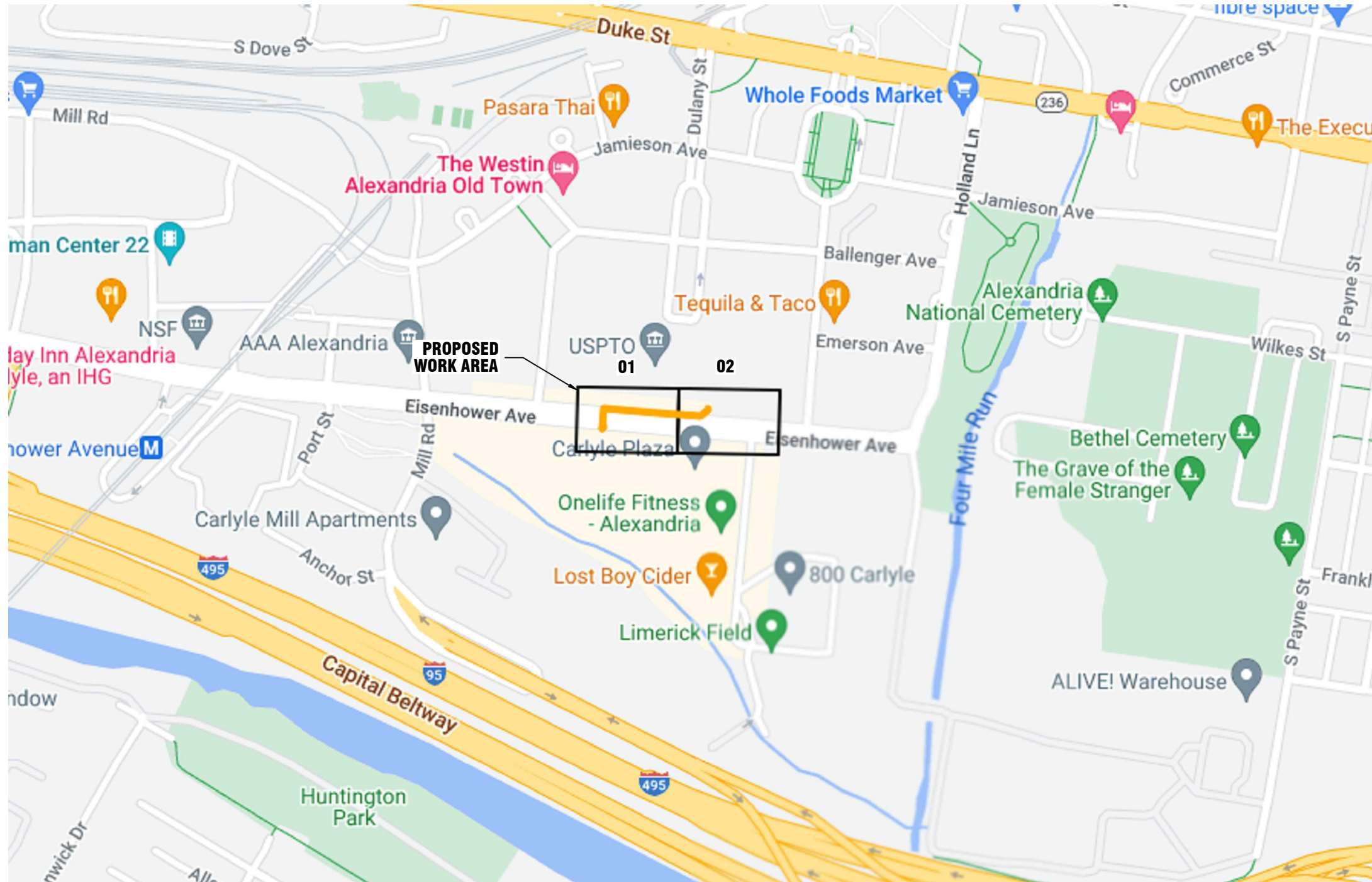
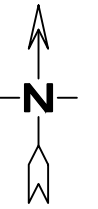

**DISCLAIMER:**  
UTILITY LOCATIONS SHOWN ON THIS DRAWING ARE APPROXIMATE AND SHOULD NOT BE SOLELY RELIED UPON TO LOCATE UNDERGROUND FACILITIES. THE CONTRACTOR SHALL BE FULLY RESPONSIBLE FOR COMPLIANCE WITH STATEWIDE AND/OR LOCAL AREA "ONE CALL" PROGRAMS AND REQUIREMENTS.

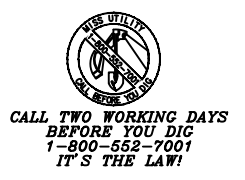

**ISSUED FOR CONSTRUCTION**



10701 STONER DR  
FREDERICKSBURG, VA 22408  
540-710-5416  
WWW.KCI.COM



600 DULANY ST SOUTH LATERAL  
PROPOSED FIBER ROUTE  
CITY OF ALEXANDRIA, VA

ISSUE DATE: 10.3.2023			
REVISION	DATE	INITIAL	DRAWN BY: JUSTIN MURPHY
			ENGINEERED BY: KCI
			ZAYO PROJECT NO: ISO-0400904
			KCI PROJECT NO: 0223076962
			EST NO:
			APPROVED BY:

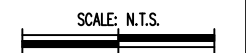

SHEET NO. T01 OF T06

**ZAYO:**

MIKE GATES 571-244-8204  
PROJECT MANAGER

**UTILITIES:**

MISS UTILITY (VA) 24 HOUR NUMBER 1-800-552-7001

**PERMITTING AGENCIES:**

ALEXANDRIA PERMIT & PLAN KIMBERLY MERRITT 703-746-4056

**KCI:**

PETER MILEWSKI (540) 220-6319  
SR. PROJECT MANAGER

SANDRA JOHNSON (540) 895-2194  
PERMIT SPECIALIST

JUSTIN MURPHY (540) 710-5416  
DESIGNER IV

NOTE: THIS INFORMATION IS OR WILL BE BASED ON AREA OF WORK

**SYMBOLS**

ELECTRIC	
⊙	ELECTRIC MANHOLE
⊠	ELECTRIC TRANSFORMER
⊗	POWER POLE
△	PARKING METER
○	STREET LIGHT
⊠	TRAFFIC CONTROL BOX
○	TRAFFIC POLE
⊕	TRAFFIC SIGNAL

GAS	
⊙	GAS MANHOLE
⊕	GAS VALVE

SEWER/STORM	
⊙	SEWER MANHOLE
⊙	STORM DRAIN MANHOLE
⊠	GRATE INLET
⊠	CATCH BASIN

WATER	
⊙	WATER MANHOLE
⊕	WATER VALVE
⊠	WATER METER
○	FIRE HYDRANT
⊕	IRRIGATION VALVE

TELEPHONE	
⊙	TELEPHONE MANHOLE
⊠	TELEPHONE HH
⊠	PROPOSED HH
⊠	PROPOSED MANHOLE
X	ANCHOR
⊠	TELEPHONE PEDESTAL
⊠	PROPOSED PEDESTAL
⊗	TELEPHONE POLE
⊠	VERIZON MANHOLE
⊠	FIBER MARKER TUBE
X	PROPOSED ANCHOR
??L-6.6M 5/8"	PROPOSED ANCHOR TEXT
∞	PROPOSED AERIAL SLACK COIL
⊠	PROP AERIAL SPLICE
⊙	PROPOSED POLE

GENERAL	
▽	SIGN
⬡	STEEL POLE
⊙	STEEL POST
⊙	PROPERTY PIN
⊠	CONCRETE POLE
⊕	TEST PIT
⊠	MAILBOX
⊙	TREE

LINETYPES					
———	B/E	BUILDING EDGE	———	FOC	PROPERTY LINE
———	CATV	CABLE TV	———	PROPOSED FIBER LINE	
———	FOC	CENTER LINE	———	PROPOSED PULL THRU	
———	D/L	DITCH LINE		RAILROAD	
———	EOP	EDGE OF PAVEMENT	———	R/W	RIGHT-OF-WAY
———	E	ELECTRIC	———	S	SEWER LINE
———	FOC	FACE OF CURB	———	SD	STORM DRAIN
—X—X—X—X—X—	FENCE		———	T	TELEPHONE LINE
———	SLOPE - TOP		———	TR	TRAFFIC SIGNAL LINE
———	G	GAS LINE	———	W	WATER LINE
———	GUARDRAIL		~~~~~		WOODS/LANDSCAPING

DISCLAIMER:  
UTILITY LOCATIONS SHOWN ON THIS DRAWING ARE APPROXIMATE AND SHOULD NOT BE SOLELY RELIED UPON TO LOCATE UNDERGROUND FACILITIES. THE CONTRACTOR SHALL BE FULLY RESPONSIBLE FOR COMPLIANCE WITH STATEWIDE AND/OR LOCAL AREA "ONE CALL" PROGRAMS AND REQUIREMENTS.

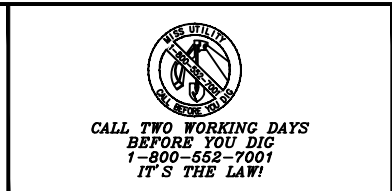

**ISSUED FOR CONSTRUCTION**



600 DULANY ST SOUTH LATERAL  
PROPOSED FIBER ROUTE  
CITY OF ALEXANDRIA, VA

ISSUE DATE: 10.3.2023			
REVISION	DATE	INITIAL	DRAWN BY: JUSTIN MURPHY
			ENGINEERED BY: KCI
			ZAYO PROJECT NO: ISO-0400904
			KCI PROJECT NO: 0223076962
			EST NO:
			APPROVED BY:

SCALE: N.T.S.  
SHEET NO. T02 OF T06



**GENERAL NOTES:**

1. ALL WORK WILL COMPLY WITH APPLICABLE LOCAL, STATE, AND FEDERAL REGULATORY AGENCIES, INCLUDING, BUT NOT LIMITED TO, OSHA, NESC, DOT, RPA, ETC. GENERAL NOTES WILL APPLY TO ALL DRAWINGS.
2. THE CONTRACTOR WILL NOTIFY (IF APPLICABLE) THE ADJACENT PROPERTY OWNERS A MINIMUM OF 24 HOURS IN ADVANCE OF CONSTRUCTION.
3. ALL TRAFFIC CONTROL DEVICES WILL BE IN PLACE PRIOR TO CONSTRUCTION. DEVICES NO LONGER NEEDED WILL BE REMOVED AS QUICKLY AS POSSIBLE.
4. PEDESTRIAN TRAFFIC AREAS MUST BE MAINTAINED AT ALL TIMES. PEDESTRIANS WILL NOT BE ROUTED ON TO PRIVATE PROPERTY.
5. NO MATERIALS OR EQUIPMENT WILL BE STORED OR ALLOWED TO STAND UNPROTECTED WHERE PEDESTRIAN OR VEHICULAR TRAFFIC IS PRESENT.
6. NO EQUIPMENT OR MATERIALS WILL BE STORED ON ROAD SURFACE DURING NON-WORK PERIODS.
7. NO EQUIPMENT OR MATERIALS MAY BE STORED ON THE SIDEWALK.
8. EXCAVATION MATERIAL WILL BE STORED AWAY FROM THE PAVED ROADWAY. ALL SPILLED MATERIAL WILL BE PICKED UP IMMEDIATELY.
9. MUNICIPAL ROAD SIGNS, DELINEATORS, GUARDRAILS, ETC. WILL NOT BE REMOVED WITHOUT PRIOR WRITTEN PERMISSION FROM THE APPROVING AUTHORITY.
10. ALL WORK WILL BE PERFORMED IN ACCORDANCE WITH THE CITY, COUNTY, AND STATE SPECIFICATIONS AND STANDARDS.

**DATES OF CONSTRUCTION:**

CONSTRUCTION ON THE RIGHT OF WAY IS PLANNED TO BE A YEAR ROUND ACTIVITY. SOILS DATA FOR SOILS MAP AND SOILS INFORMATION PROVIDED.

**EROSION SEDIMENTATION CONTROL PROGRAM:**

EROSION AND SEDIMENTATION CONTROLS SHOWN ARE PROVIDED TO ACCOMMODATE ONSITE DRAINAGE AREAS DURING THE CONSTRUCTION PHASE. ADDITIONAL OR REVISED CONTROLS MAY BE INSTALLED AS DETERMINED NECESSARY. EROSION AND SEDIMENTATION CONTROL MEASURES SHALL BE CONSTRUCTED AND MAINTAINED ACCORDING TO THE STANDARDS AND SPECIFICATIONS IN THE CURRENT VIRGINIA EROSION AND SEDIMENT CONTROL HANDBOOK.

**PHASE OF LAND DISTURBING ACTIVITIES:**

CONTROLS SHOWN SHALL BE INSTALLED AS THE FIRST ITEM OF CONSTRUCTION AND MAINTAINED FOR CONSTRUCTION ACTIVITIES LASTING MORE THAN A ONE DAY SCHEDULE. ALL AREAS NOT TO BE IMMEDIATELY BUILT UPON SHALL BE SEEDED FOR TEMPORARY VEGETATION. ALL CONTROLS ARE TO REMAIN IN PLACE FOR THE DURATION OF THE JOB. REMOVAL, REGRADING AND SEEDING OF THE TEMPORARY DIVERSION DIKES WILL BE THE FINAL ACT OF GRADING IF REQUIRED.

**SEQUENCE OF CONSTRUCTION:**

1. PLACEMENT OF EROSION AND SEDIMENTATION CONTROLS
2. TRENCHING AND/OR DIRECTIONAL BORING
3. UTILITY INSTALLATION
4. FINAL GRADING AND VEGETATION
5. REMOVAL OF CONTROLS

**GENERAL LAND CONSERVATION NOTES:**

1. NO DISTURBED AREA WILL BE DENUDED FOR MORE THAN SEVEN (7) CALENDAR DAYS UNLESS AUTHORIZED BY CITY OF ALEXANDRIA, VA.
2. ALL EROSION AND SEDIMENTATION CONTROL MEASURES SHALL BE PLACED AS THE FIRST STEP IN GRADING.
3. ELECTRIC POWER, TELEPHONE AND GAS SUPPLY TRENCHES SHALL BE COMPACTED, SEEDED AND MULCHED. WITHIN FIVE (5) DAYS OF BACKFILL.
4. ALL TEMPORARY EARTH BERMS, DIVERSION DIKES, SILT DAMS, AND SOIL STOCKPILES SHALL BE SEEDED AND MULCHED FOR TEMPORARY VEGETATIVE COVER IMMEDIATELY AFTER GRADING. STRAW OR HAY IS REQUIRED.
5. DURING CONSTRUCTION, ALL STORM SEWER INLETS SHALL BE PROTECTED BY SILT TRAPS MAINTAINED AND MODIFIED AS REQUIRED DURING CONSTRUCTION PROGRESS.
6. ANY DISTURBED AREA NOT COVERED BY NOTE 1 ABOVE AND NOT PAVED, SODDED, OR BUILT UPON BY NOVEMBER 1, OR DISTURBED AFTER THAT DATE, SHALL BE MULCHED WITH HAY OR STRAW MULCH AT THE RATE OF TWO (2) TONS PER ACRE AND OVER-SEEDED BY MARCH 15.
7. AT THE COMPLETION OF THE CONSTRUCTION PROJECT AND PRIOR TO RELEASE OF THE BOND, ALL TEMPORARY SILTATION AND EROSION CONTROLS SHALL BE REMOVED UPON THE APPROVAL OF CITY OF ALEXANDRIA, AND ALL DENUDED AREAS SHALL BE STABILIZED WITH VEGETATION.
8. ALL EROSION AND SEDIMENTATION CONTROL MEASURES SHALL MEET THE STANDARDS AND SPECIFICATIONS OF THE CURRENT VIRGINIA EROSION AND SEDIMENT CONTROL HANDBOOK.
9. NO MORE THAN 500 LINEAR FEET OF TRENCH MAY BE OPENED AT ONE TIME.
10. EXCAVATION MATERIAL SHALL BE PLACED ON THE UPHILL SIDE OF THE TRENCH.
11. EFFLUENT FROM THE DEWATERING OPERATIONS SHALL BE FILTERED OR PASSED THROUGH AN APPROVED SEDIMENT TRAPPING DEVICE, OR BOTH, AND DISCHARGED IN A MANNER THAT DOES NOT ADVERSELY AFFECT FLOWING STREAMS OR OFF-SITE PROPERTY.
12. MATERIAL USED FOR BACKFILLING TRENCHES SHALL BE PROPERLY COMPACTED IN ORDER TO MINIMIZE EROSION AND PROMOTE STABILIZATION.
13. RESTABILIZATION SHALL BE ACCOMPLISHED IN ACCORDANCE WITH THESE REGULATIONS.
14. APPLICABLE SAFETY REGULATIONS SHALL BE COMPLIED WITH.
15. WHERE CONSTRUCTION VEHICLE ACCESS ROUTES INTERSECT PAVED OR PUBLIC ROADS, PROVISIONS SHALL BE MADE TO MINIMIZE THE TRANSPORT OF SEDIMENT BY VEHICULAR TRACKING ONTO THE PAVED SURFACE. WHERE SEDIMENT IS TRANSPORTED ONTO A PAVED OR PUBLIC ROAD SURFACE, THE ROAD SURFACE SHALL BE CLEANED THOROUGHLY AT THE END OF EACH DAY. SEDIMENT SHALL BE REMOVED FROM THE ROADS BY SHOVELING OR SWEEPING AND TRANSPORTED TO A SEDIMENT CONTROL DISPOSAL AREA. STREET WASHING SHALL BE ALLOWED ONLY AFTER SEDIMENT IS REMOVED IN THIS MANNER.

**CONSTRUCTION NOTES:**

1. FIBER OPTIC WARNING TAPE WILL BE PLACED 12" BELOW THE EXISTING GRADE IN ALL EXCAVATIONS.
2. VERIFICATION OF THE LOCATION OF EXISTING UTILITY CROSSINGS IS THE RESPONSIBILITY OF THE CONTRACTOR. HAND DIGGING WILL BE UTILIZED WHERE REQUIRED.
3. CALL THE LOCAL UTILITY ONE-CALL AT LEAST 72 HOURS IN ADVANCE OF ANY CONSTRUCTION. 1-800-552-7001
4. A 12" SEPARATION BETWEEN PROPOSED CONDUIT AND OTHER UTILITIES WILL BE MAINTAINED.
5. CONDUIT CAPS WILL BE PLACED ON THE ENDS OF ALL VACANT DUCTS DURING CONSTRUCTION, UPON COMPLETION, AND WHILE AWAITING FIBER INSTALLATION.
6. ALL INSTALL DUCTS WILL BE PROOFED USING A MANDRILL 1/4" SMALLER THAN THE PIPE ID PVC AS SHOWN ON DRAWING.
7. THE MINIMUM BENDING RADIUS FOR FIBER CABLE WILL BE 36".
8. MAXIMUM CABLE INSTALLATION TENSION WILL NOT EXCEED 600 POUNDS. A 600 POUND BREAKAWAY SWIVEL WILL BE USED DURING PULLING.
9. THE REMOVAL AND STORAGE OF ALL SHRUBBERY TO BE REPLACED IS THE RESPONSIBILITY OF THE CONTRACTOR.
10. THE CONTRACTOR WILL RESTORE ALL DISTURBED AREAS TO THEIR ORIGINAL OR BETTER CONDITION.
11. IT IS THE RESPONSIBILITY OF THE CONTRACTOR TO MAINTAIN CONSTRUCTION AS-BUILT DRAWINGS AND PRESENT A COMPLETE SET OF RED-LINED DRAWINGS TO ZAYO WITHIN 14 DAYS OF COMPLETION OF THE WORK.
12. CONDUITS WILL BE TERMINATED ABOVE THE MIDPOINT OF MANHOLE.
13. PLACE 100 FEET FIBER SLACK COIL IN EACH HANDHOLE/MANHOLE.
14. HAND DIG UNDER ANY BURIED UTILITY CABLES AS REQUIRED.
15. ALL CONDUITS WILL BE PLACED AT A MINIMUM OF 36" COVER UNLESS ROCK IS ENCOUNTERED. IN CASE OF ROCK, CONDUIT MAY BE PLACED AT A MINIMUM OF 36" INCHES AND ENCASED IN STEEL PIPE SIZED APPROPRIATELY. IF 36" COVER IS NOT ACHIEVABLE THE ROCK MUST BE EXCAVATED TO A MINIMUM DEPTH OF 24" INCHES AND THE CONDUIT MUST BE ENCASED IN CONCRETE.

**DISCLAIMER:**  
UTILITY LOCATIONS SHOWN ON THIS DRAWING ARE APPROXIMATE AND SHOULD NOT BE SOLELY RELIED UPON TO LOCATE UNDERGROUND FACILITIES. THE CONTRACTOR SHALL BE FULLY RESPONSIBLE FOR COMPLIANCE WITH STATEWIDE AND/OR LOCAL AREA "ONE CALL" PROGRAMS AND REQUIREMENTS.

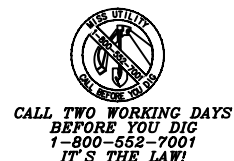

**ISSUED FOR CONSTRUCTION**

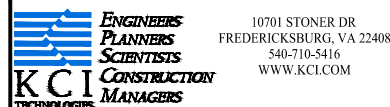

600 DULANY ST SOUTH LATERAL  
PROPOSED FIBER ROUTE  
CITY OF ALEXANDRIA, VA

ISSUE DATE: 10.3.2023			
REVISION	DATE	INITIAL	DRAWN BY: JUSTIN MURPHY
			ENGINEERED BY: KCI
			ZAYO PROJECT NO: ISO-0400904
			KCI PROJECT NO: 0223076962
			EST NO:
			APPROVED BY:

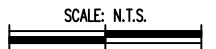

SHEET NO. T03 OF T06

**SOD/UNIMPROVED AREA TRENCH RESTORATION TYPICAL**

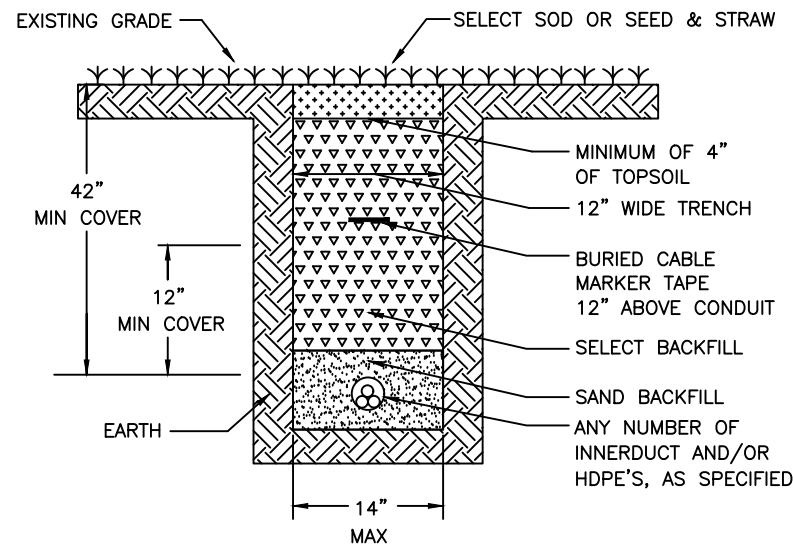

1. ALL BACKFILL MUST BE APPROVED BY ENGINEER OR PERMITTING AUTHORITY INSPECTOR.
2. EXCAVATED MATERIAL MAY BE DEEMED SUITABLE BACKFILL BY ENGINEER, AND/OR PERMITTING AUTHORITY.
3. A MAXIMUM OF EIGHT (8) INCH LIFTS OF BACKFILL MATERIAL WILL BE ALLOWED. FOUR (4) INCHES OF CLEAN SAND SHALL BE PLACED ABOVE THE CONDUIT.
4. THE BOTTOM OF THE TRENCH SHALL BE LEVEL, FLAT, AND NOT HAVE ANY ROCK DEBRIS.
5. ALL DISTURBED GRASS AREAS ARE TO BE SEEDED WITH KENTUCKY 31 FESCUE WITH NUTRIENTS APPLIED AND MAINTAINED TO ACHIEVE A SATISFACTORY GRASS COVER TO CONTROL EROSION.

**MICROTRENCH PROFILE TYPICAL**

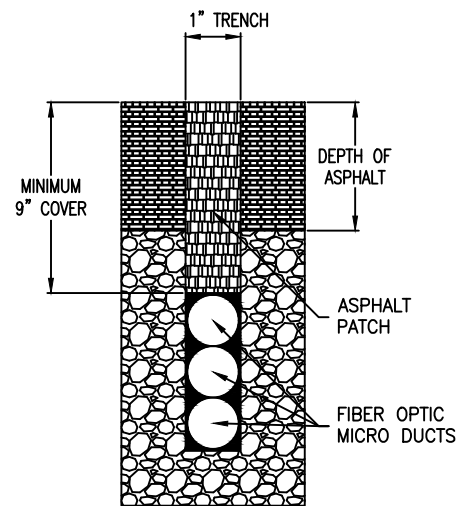

**HDPE CONDUIT CONFIGURATION**

**TYPICAL "C"**

CABLE IN CONDUIT

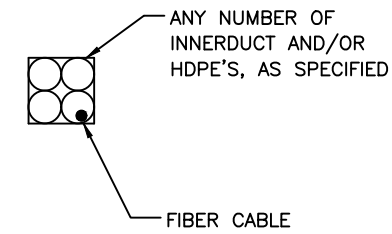

**TYPICAL "D"**

MULTIPLE CABLE IN CONDUIT

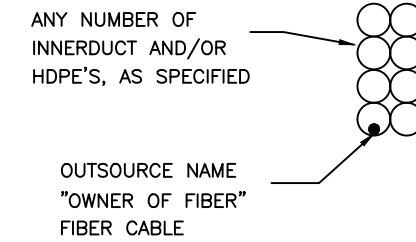

**PLACEMENT - TYPICALS**

**TYPICAL "A"**

PLACE CONDUIT CROSS SECTION

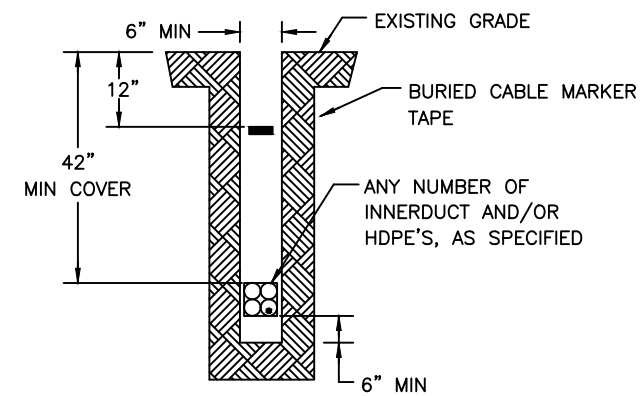

**TYPICAL "B"**

PLACE HDPE (DIRECTIONAL BORE) CROSS SECTION

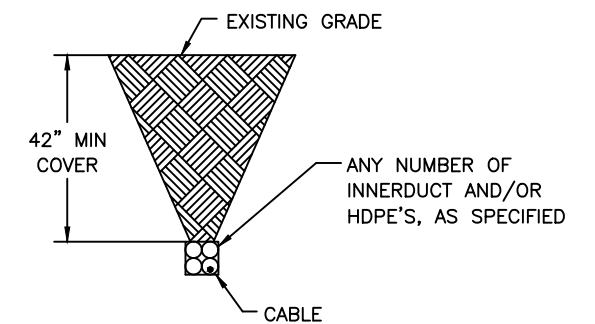

NOTE:  
BACKFILL MUST BE MADE WITH ROCK FREE MATERIAL

DISCLAIMER:  
UTILITY LOCATIONS SHOWN ON THIS DRAWING ARE APPROXIMATE AND SHOULD NOT BE SOLELY RELIED UPON TO LOCATE UNDERGROUND FACILITIES. THE CONTRACTOR SHALL BE FULLY RESPONSIBLE FOR COMPLIANCE WITH STATEWIDE AND/OR LOCAL AREA "ONE CALL" PROGRAMS AND REQUIREMENTS.

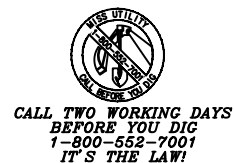

**ISSUED FOR CONSTRUCTION**



10701 STONER DR  
FREDERICKSBURG, VA 22408  
540-710-5416  
WWW.KCI.COM



600 DULANY ST SOUTH LATERAL  
PROPOSED FIBER ROUTE  
CITY OF ALEXANDRIA, VA

ISSUE DATE: 10.3.2023

REVISION	DATE	INITIAL	DRAWN BY: JUSTIN MURPHY
			ENGINEERED BY: KCI
			ZAYO PROJECT NO: ISO-0400904
			KCI PROJECT NO: 0223076962
			EST NO:
			APPROVED BY:

SCALE: N.T.S.

SHEET NO. T04 OF T06

## 2' x 3' x 3' HANDHOLE

### COVER FEATURES:

- \* STANDARD LOAD RATING: 20,800 LBS. WHEEL LOAD ON 10" X 20" PLATE
- \* 2 BOLT DOWN LOCATIONS
- \* STAINLESS STEEL BOX INSERTS
- \* POLYMER CONCRETE CONSTRUCTION
- \* NON-SKID SURFACE (STANDARD)
- \* 20K TO BE EMBOSSED ON TOP
- \* APPROX. WEIGHT 120 LBS.

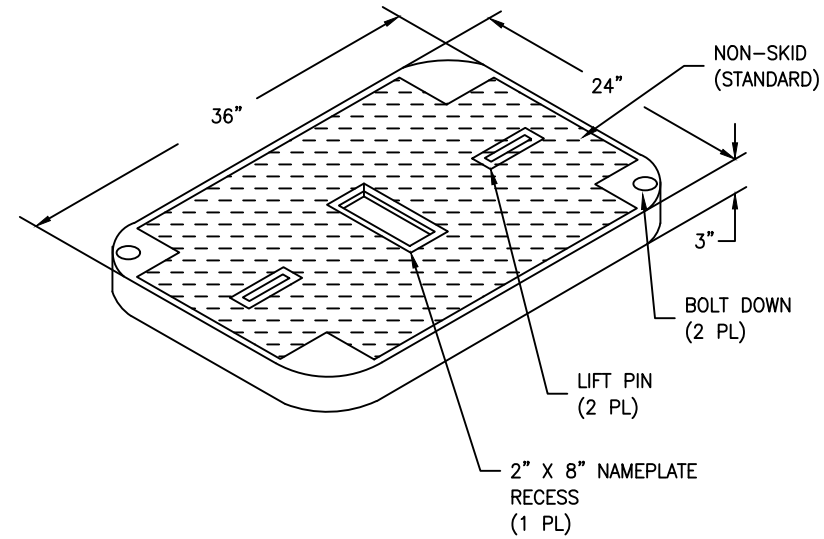

### BOX FEATURES:

- POLYMER CONCRETE CONSTRUCTION
- \* LIGHTWEIGHT
- \* STACKABLE
- \* APPROX. WEIGHT 300 LBS.

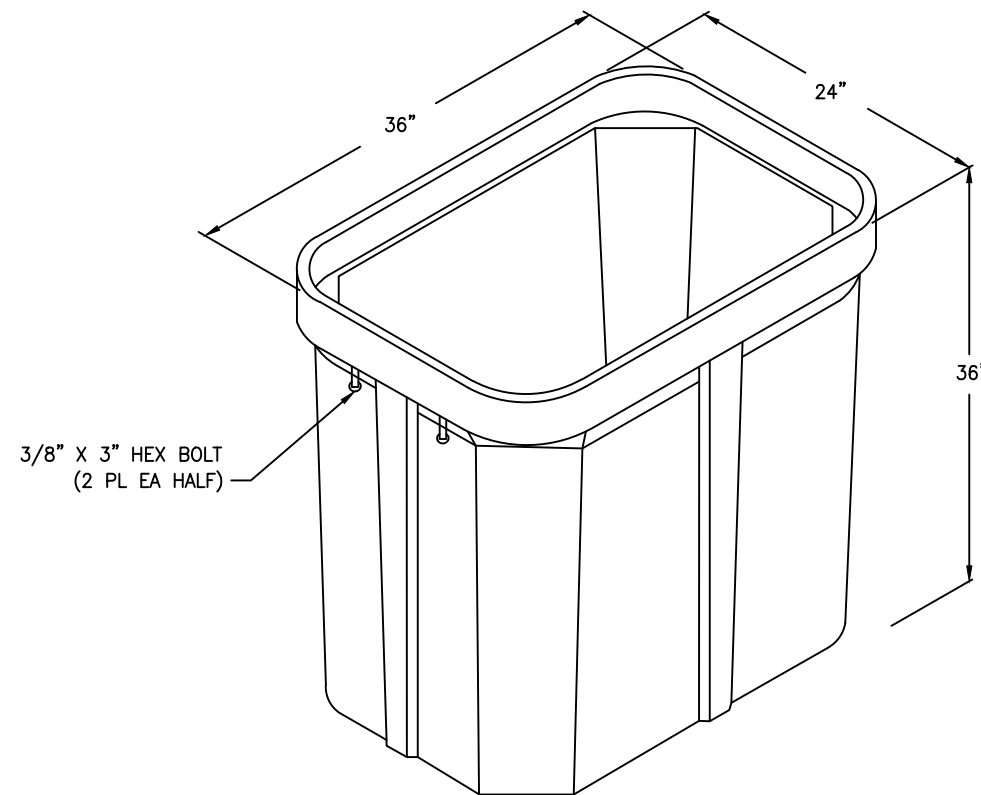

**DISCLAIMER:**  
UTILITY LOCATIONS SHOWN ON THIS DRAWING ARE APPROXIMATE AND SHOULD NOT BE SOLELY RELIED UPON TO LOCATE UNDERGROUND FACILITIES. THE CONTRACTOR SHALL BE FULLY RESPONSIBLE FOR COMPLIANCE WITH STATEWIDE AND/OR LOCAL AREA "ONE CALL" PROGRAMS AND REQUIREMENTS.

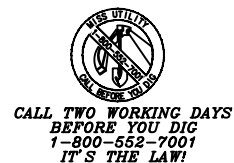

**ISSUED FOR  
CONSTRUCTION**

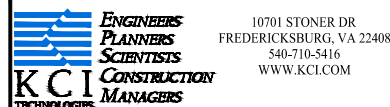

600 DULANY ST SOUTH LATERAL  
PROPOSED FIBER ROUTE  
CITY OF ALEXANDRIA, VA

ISSUE DATE: 10.3.2023

REVISION	DATE	INITIAL	DRAWN BY: JUSTIN MURPHY
			ENGINEERED BY: KCI
			ZAYO PROJECT NO: ISO-0400904
			KCI PROJECT NO: 0223076962
			EST NO:
			APPROVED BY:

SCALE: N.T.S.



SHEET NO. T05 OF T06

PROJECT SUMMARY FOR 600 DULANY ST SOUTH LATERAL		
DESCRIPTION	QUANTITY	UNIT
72 FIBER (INCLUDES SLACK SOILS + 5%)	869	FT
1.25" HDPE + 10%	17	FT
2'X3'X3' HANDHOLE	1	EA
SPLICE CASE	1	EA

FIBER REEL LENGTHS +5%
REEL #1 (72 FIBER) = 869'

DISCLAIMER:  
UTILITY LOCATIONS SHOWN ON THIS  
DRAWING ARE APPROXIMATE AND SHOULD  
NOT BE SOLELY RELIED UPON TO LOCATE  
UNDERGROUND FACILITIES. THE  
CONTRACTOR SHALL BE FULLY  
RESPONSIBLE FOR COMPLIANCE WITH  
STATEWIDE AND/OR LOCAL AREA "ONE  
CALL" PROGRAMS AND REQUIREMENTS.

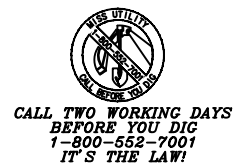

**ISSUED FOR  
CONSTRUCTION**



10701 STONER DR  
FREDERICKSBURG, VA 22408  
540-710-5416  
WWW.KCI.COM



600 DULANY ST SOUTH LATERAL  
PROPOSED FIBER ROUTE  
CITY OF ALEXANDRIA, VA

ISSUE DATE: 10.3.2023

REVISION	DATE	INITIAL	DRAWN BY: JUSTIN MURPHY
			ENGINEERED BY: KCI
			ZAYO PROJECT NO: ISO-0400904
			KCI PROJECT NO: 0223076962
			EST NO:
			APPROVED BY:

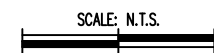

**CITY OF ALEXANDRIA, VA  
PLAN VIEW**

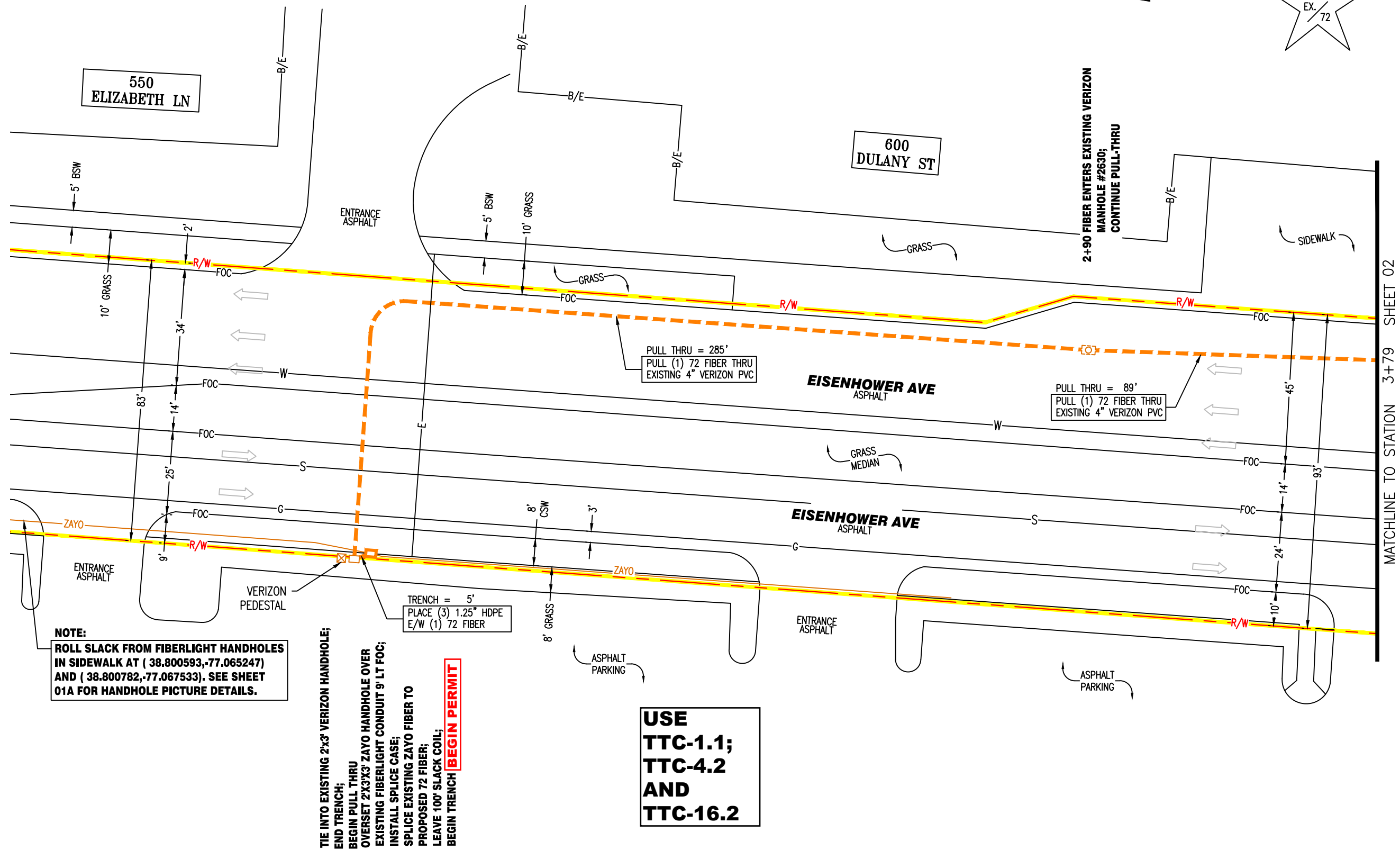
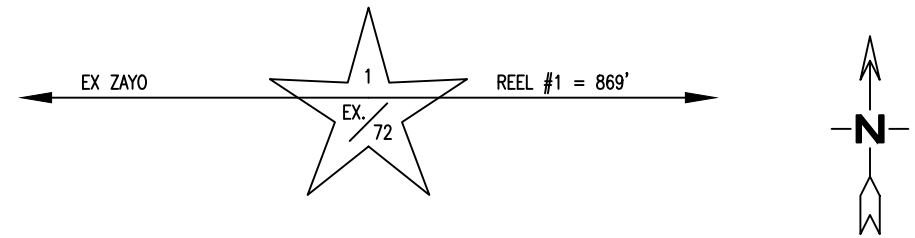

**NOTE:**  
ROLL SLACK FROM FIBERLIGHT HANDHOLES IN SIDEWALK AT ( 38.800593,-77.065247) AND ( 38.800782,-77.067533). SEE SHEET 01A FOR HANDHOLE PICTURE DETAILS.

0+05 TIE INTO EXISTING 2"x3" VERIZON HANDHOLE;  
END TRENCH;  
BEGIN PULL THRU  
0+00 OVERSET 2"x3"x3" ZAYO HANDHOLE OVER EXISTING FIBERLIGHT CONDUIT 9" LT FOC;  
INSTALL SPLICE CASE;  
SPLICE EXISTING ZAYO FIBER TO PROPOSED 72 FIBER;  
LEAVE 100' SLACK COIL;  
BEGIN TRENCH **BEGIN PERMIT**

TRENCH = 5'  
PLACE (3) 1.25" HDPE  
E/W (1) 72 FIBER

**USE  
TTC-1.1;  
TTC-4.2  
AND  
TTC-16.2**

MATCHLINE TO STATION 3+79 SHEET 02

RIGHT OF WAY DERIVED FROM CITY OF ALEXANDRIA VA GIS.

DISCLAIMER:  
UTILITY LOCATIONS SHOWN ON THIS DRAWING ARE APPROXIMATE AND SHOULD NOT BE SOLELY RELIED UPON TO LOCATE UNDERGROUND FACILITIES. THE CONTRACTOR SHALL BE FULLY RESPONSIBLE FOR COMPLIANCE WITH STATEWIDE AND/OR LOCAL AREA "ONE CALL" PROGRAMS AND REQUIREMENTS.

**ISSUED FOR  
CONSTRUCTION**

600 DULANY ST SOUTH LATERAL  
PROPOSED FIBER ROUTE  
CITY OF ALEXANDRIA, VA

ISSUE DATE: 10.3.2023

REVISION	DATE	INITIAL	DRAWN BY: JUSTIN MURPHY
			ENGINEERED BY: KCI
			ZAYO PROJECT NO: ISO-0400904
			KCI PROJECT NO: 0223076962
			EST NO:
			APPROVED BY:

SCALE: 1"=30'

SHEET NO. 01 OF 03



**CITY OF ALEXANDRIA, VA  
HANDHOLE PICTURES**



**PICTURE '1'**  
**FIBERLIGHT HANDHOLE AT  
MILLS RD INTERSECTION**  
SCALE: N.T.S.

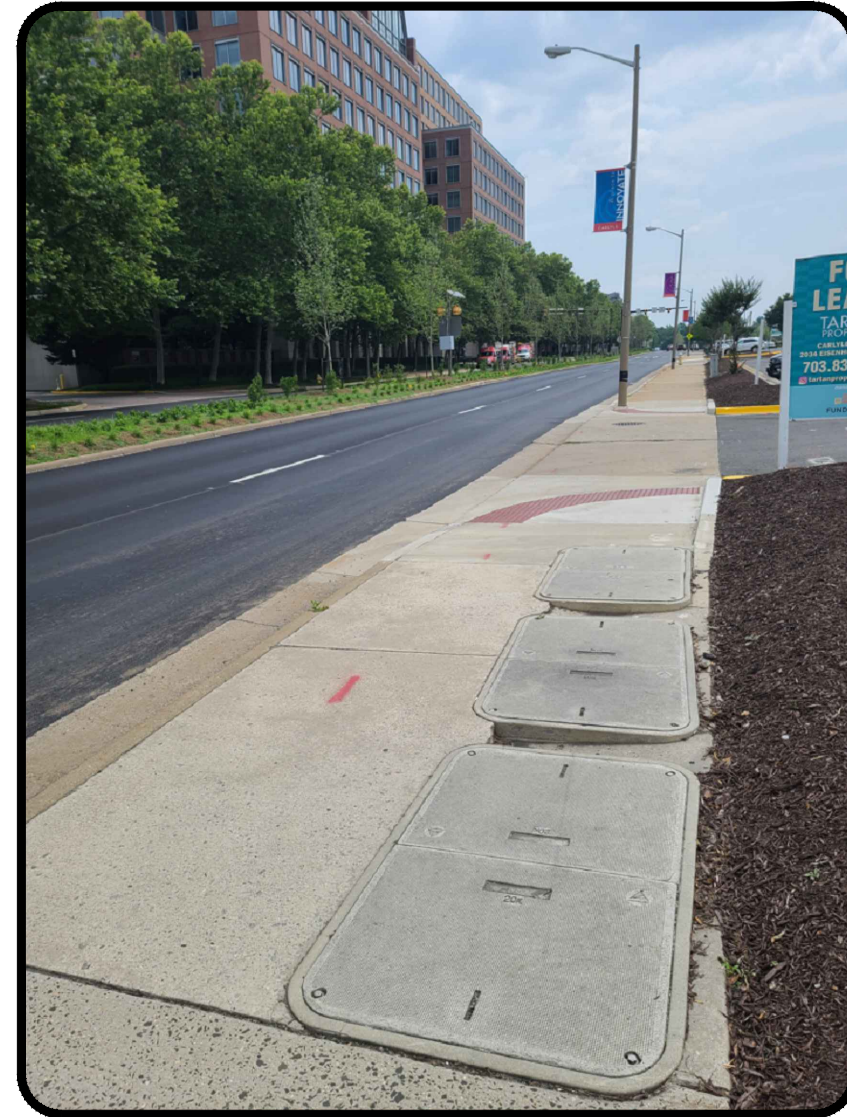

**PICTURE '2'**  
**FIBERLIGHT HANDHOLE EAST OF  
ELIZABETH LN INTERSECTION**  
SCALE: N.T.S.

DISCLAIMER:  
UTILITY LOCATIONS SHOWN ON THIS  
DRAWING ARE APPROXIMATE AND SHOULD  
NOT BE SOLELY RELIED UPON TO LOCATE  
UNDERGROUND FACILITIES. THE  
CONTRACTOR SHALL BE FULLY  
RESPONSIBLE FOR COMPLIANCE WITH  
STATEWIDE AND/OR LOCAL AREA "ONE  
CALL" PROGRAMS AND REQUIREMENTS.

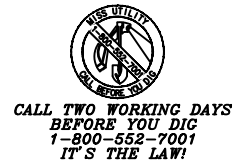

**ISSUED FOR  
CONSTRUCTION**



10701 STONER DR  
FREDERICKSBURG, VA 22408  
540-710-5416  
WWW.KCI.COM



600 DULANY ST SOUTH LATERAL  
PROPOSED FIBER ROUTE  
CITY OF ALEXANDRIA, VA

ISSUE DATE: 10.3.2023

REVISION	DATE	INITIAL	DRAWN BY: JUSTIN MURPHY
			ENGINEERED BY: KCI
			ZAYO PROJECT NO: ISO-0400904
			KCI PROJECT NO: 0223076962
			EST NO:
			APPROVED BY:

SCALE: N.T.S.



SHEET NO. 01A OF 03

**CITY OF ALEXANDRIA, VA  
PLAN VIEW**

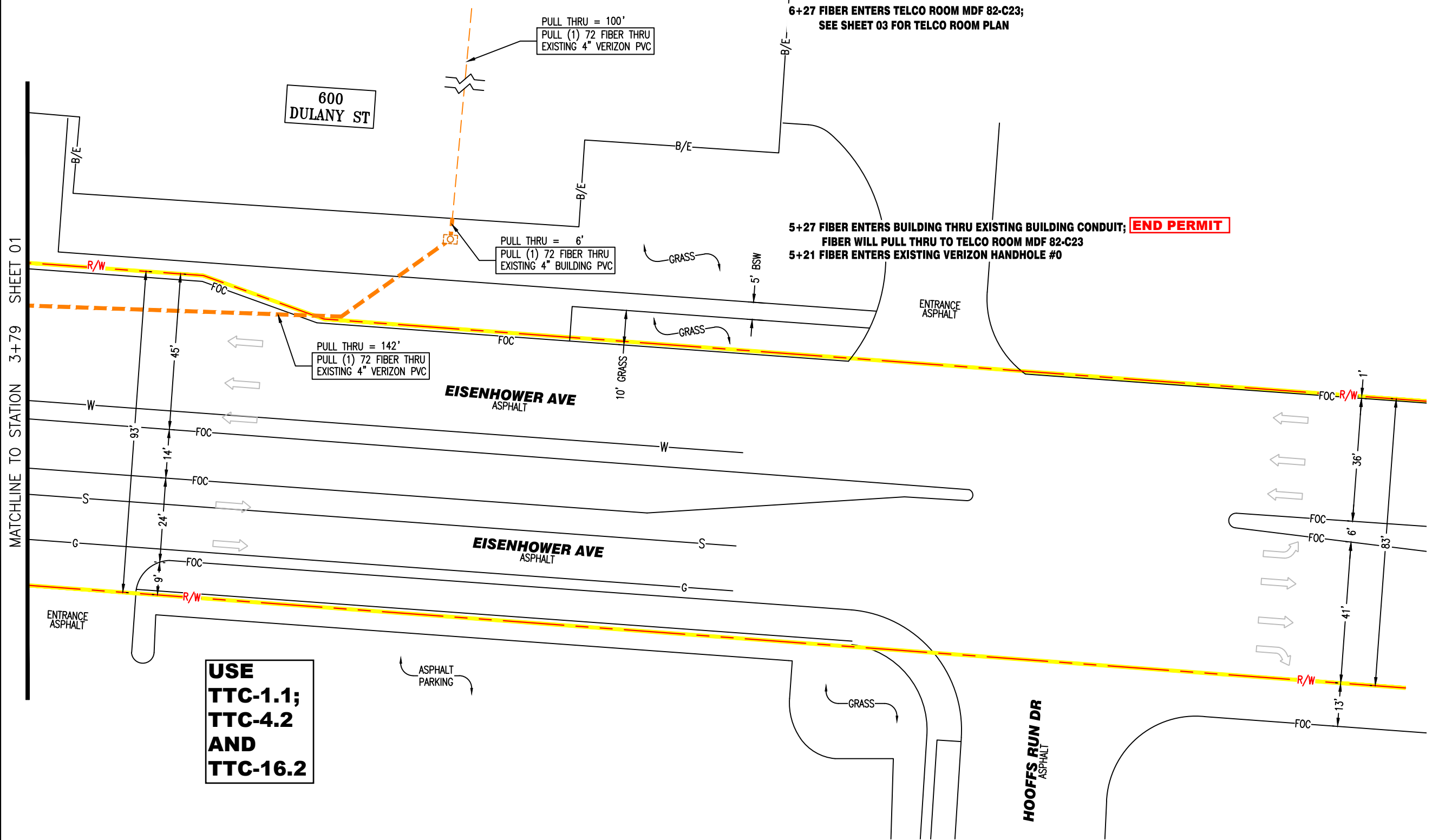
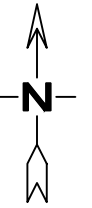

MATCHLINE TO STATION 3+79 SHEET 01

**USE  
TTC-1.1;  
TTC-4.2  
AND  
TTC-16.2**

**END PERMIT**

RIGHT OF WAY DERIVED FROM  
CITY OF ALEXANDRIA VA GIS.

DISCLAIMER:  
UTILITY LOCATIONS SHOWN ON THIS  
DRAWING ARE APPROXIMATE AND SHOULD  
NOT BE SOLELY RELIED UPON TO LOCATE  
UNDERGROUND FACILITIES. THE  
CONTRACTOR SHALL BE FULLY  
RESPONSIBLE FOR COMPLIANCE WITH  
STATEWIDE AND/OR LOCAL AREA "ONE  
CALL" PROGRAMS AND REQUIREMENTS.

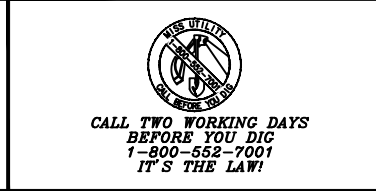

**ISSUED FOR  
CONSTRUCTION**



600 DULANY ST SOUTH LATERAL  
PROPOSED FIBER ROUTE  
CITY OF ALEXANDRIA, VA

ISSUE DATE: 10.3.2023

REVISION	DATE	INITIAL	DRAWN BY: JUSTIN MURPHY
			ENGINEERED BY: KCI
			ZAYO PROJECT NO: ISO-0400904
			KCI PROJECT NO: 0223076962
			EST NO:
			APPROVED BY:

SCALE: 1"=30'  
0 15' 30'

SHEET NO. 02 OF 03



**600 DULANY STREET  
TELCO ROOM MDF 82-C23**

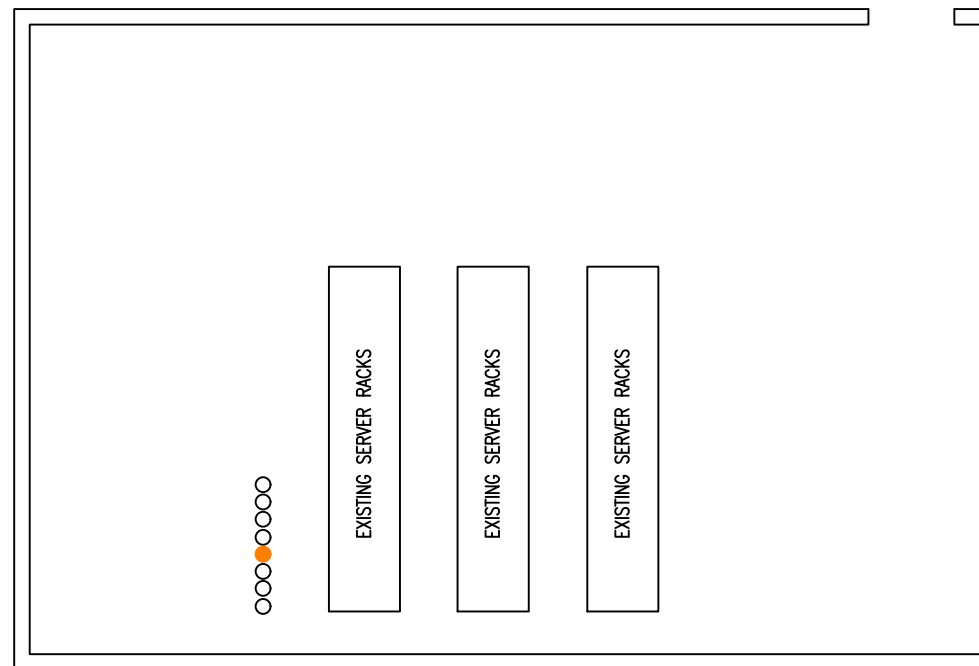

**6+27 FIBER ENTERS TELCO ROOM  
MDF 82-C23 THRU EXISTING  
4" PVC STUB-UP;  
LEAVE 100' SLACK COIL FOR TERMINATION**

DISCLAIMER:  
UTILITY LOCATIONS SHOWN ON THIS  
DRAWING ARE APPROXIMATE AND SHOULD  
NOT BE SOLELY RELIED UPON TO LOCATE  
UNDERGROUND FACILITIES. THE  
CONTRACTOR SHALL BE FULLY  
RESPONSIBLE FOR COMPLIANCE WITH  
STATEWIDE AND/OR LOCAL AREA "ONE  
CALL" PROGRAMS AND REQUIREMENTS.

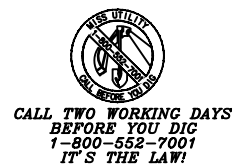

**ISSUED FOR  
CONSTRUCTION**

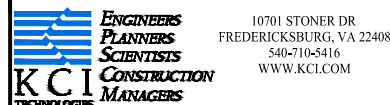

600 DULANY ST SOUTH LATERAL  
PROPOSED FIBER ROUTE  
CITY OF ALEXANDRIA, VA

ISSUE DATE: 10.3.2023			
REVISION	DATE	INITIAL	DRAWN BY: JUSTIN MURPHY
			ENGINEERED BY: KCI
			ZAYO PROJECT NO: ISO-0400904
			KCI PROJECT NO: 0223076962
			EST NO:
			APPROVED BY:

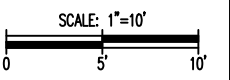

SHEET NO. 03 OF 03