

**LEGEND**

- — — — — EXISTING PROPERTY LINES
- — — — — EXISTING CONDITIONS
- - - - - PROPOSED ELLIPSE IMPROVEMENTS

PREPARED BY  
**WALTER L. PHILLIPS**  
INCORPORATED  
ESTABLISHED 1946

Engineers • Surveyors • Planners  
Landscape Architects • Arborists  
207 PARK AVENUE  
FALLS CHURCH, VIRGINIA 22046  
(703) 532-6163 Fax (703) 533-1301  
WLPINC.com

PROPERTIES FRONTING ELLIPSE  
COORDINATED DEVELOPMENT DISTRICT #21 and #22

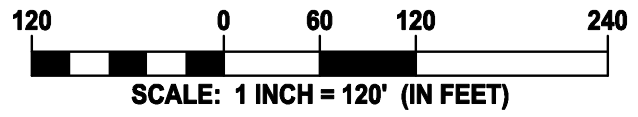



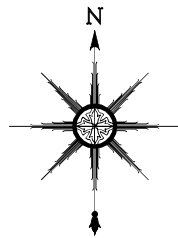



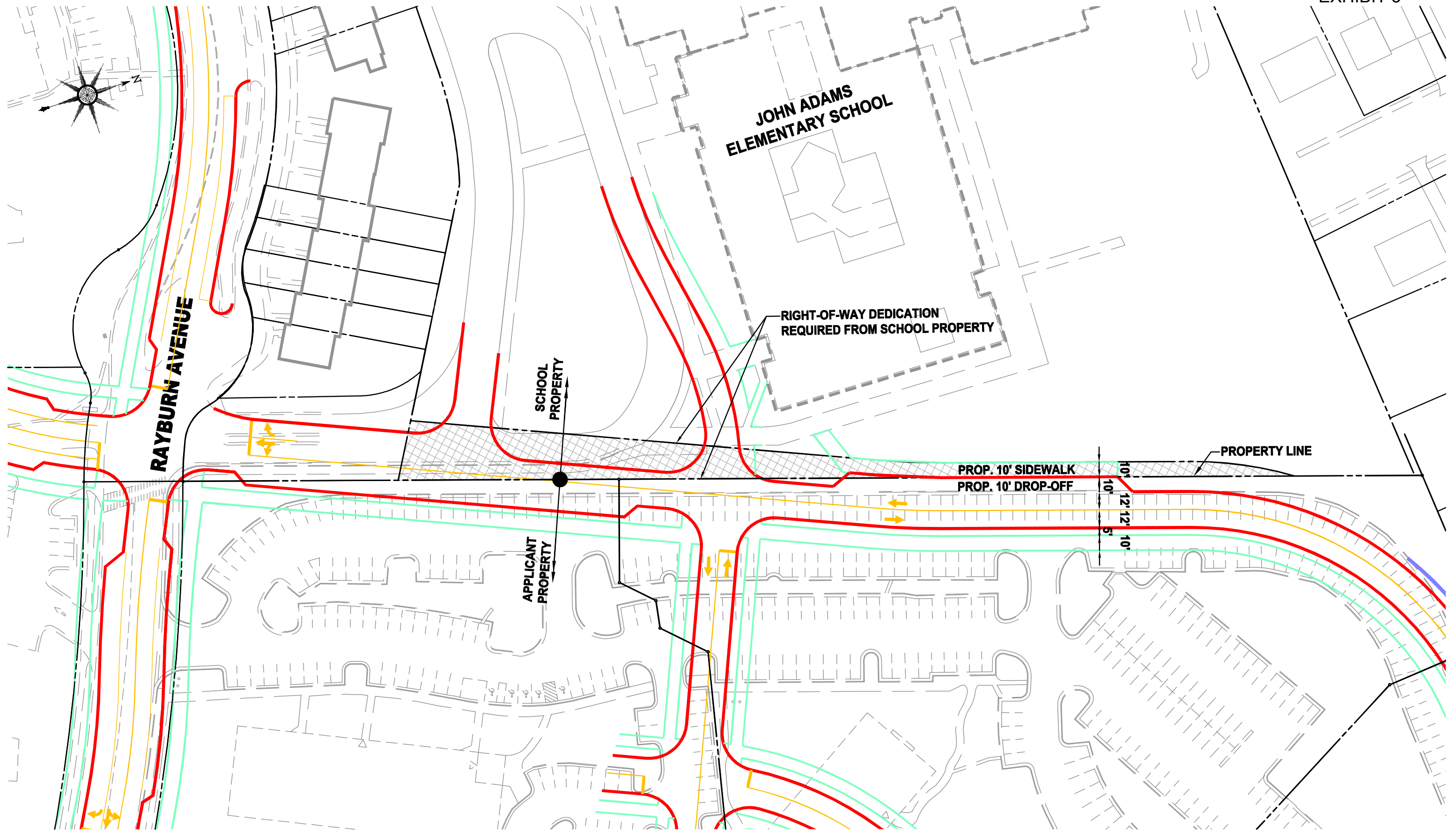

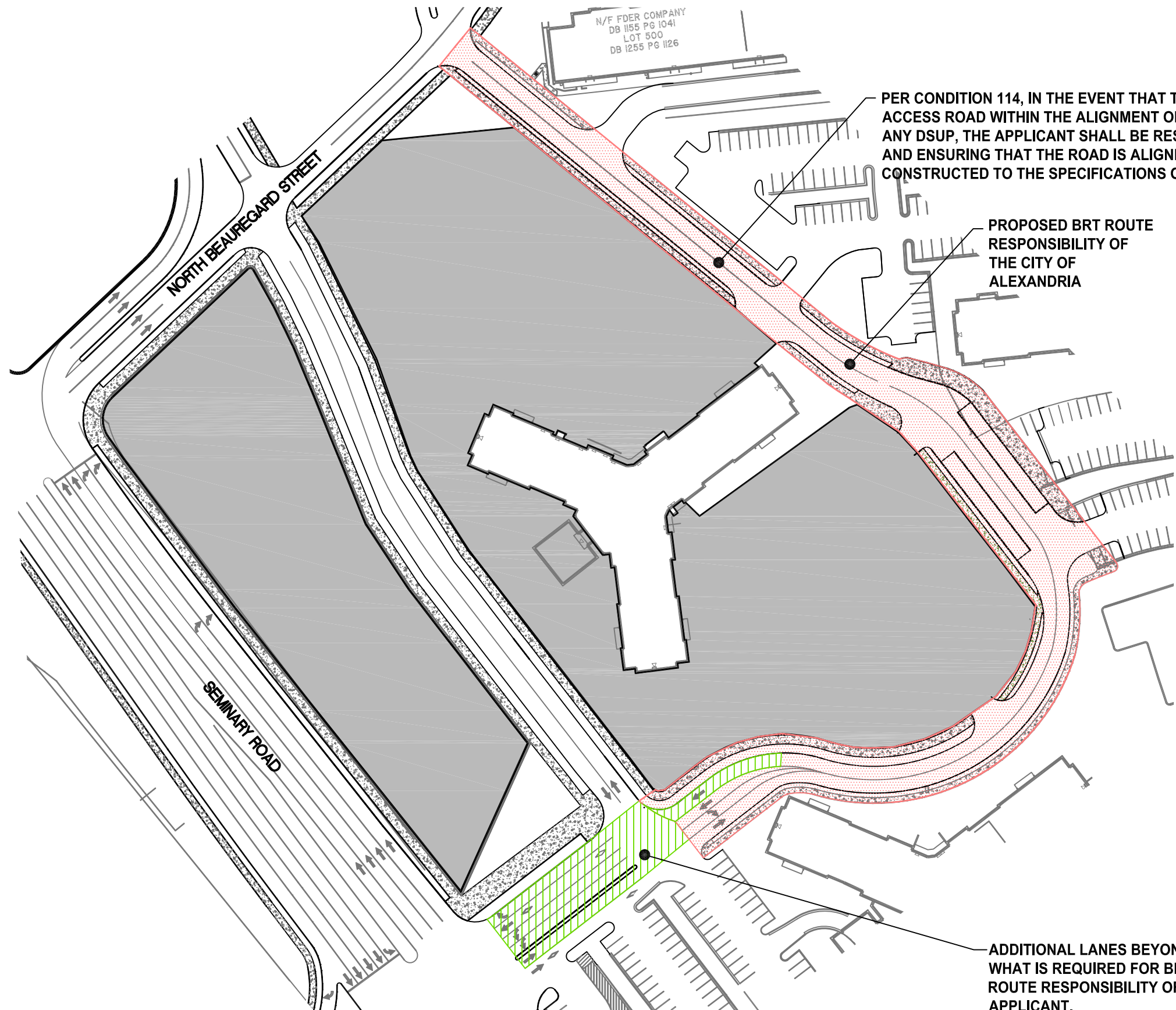
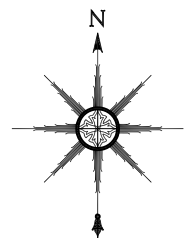

### LEGEND

-  COST RESPONSIBILITY CITY OF ALEXANDRIA
-  COST RESPONSIBILITY OF APPLICANT

## BRT TRANSITWAY in SOUTHERN TOWERS - GENERAL USE vs TRANSIT LANE RESPONSIBILITY COORDINATED DEVELOPMENT DISTRICT #21 and #22

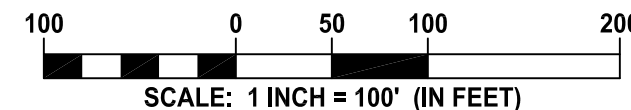



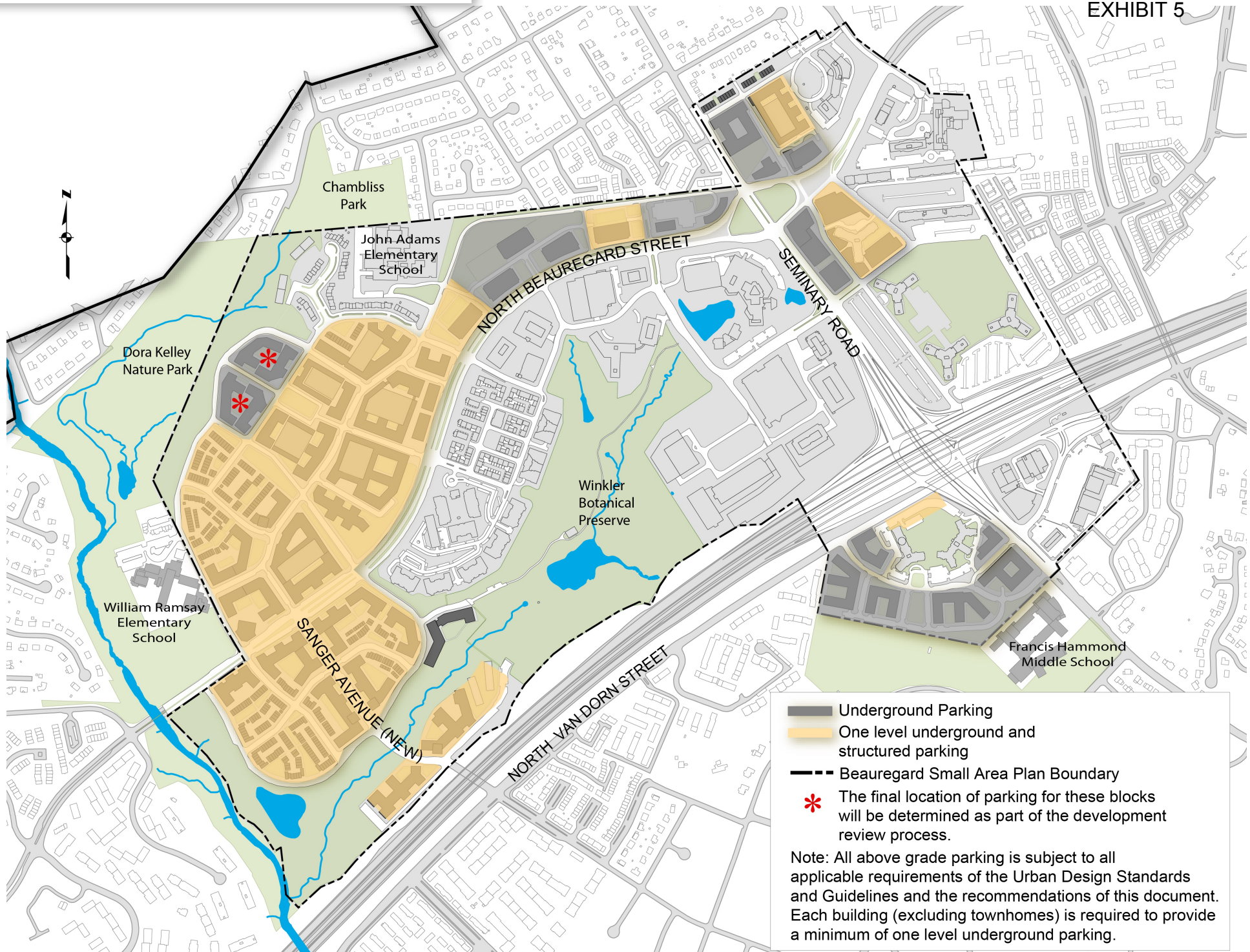



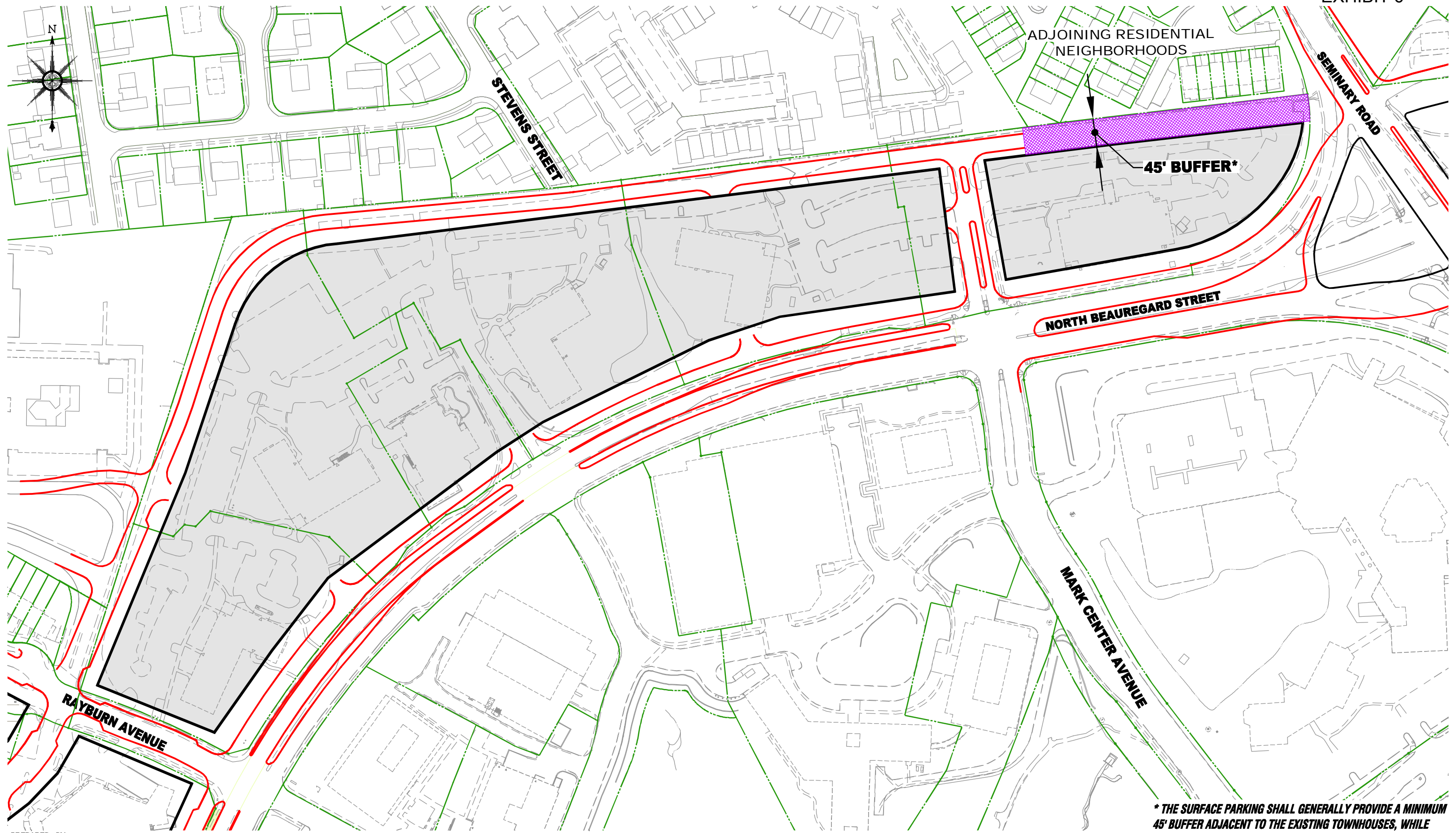

**\* THE SURFACE PARKING SHALL GENERALLY PROVIDE A MINIMUM 45' BUFFER ADJACENT TO THE EXISTING TOWNHOUSES, WHILE ACCOMMODATING REQUIRED ENTRANCES AND CIRCULATION.**

150 0 75 150 300

**SCALE: 1 INCH = 150' (IN FEET)**